

AVALON WATERWAYS

CHARTERS & INCENTIVE RIVER CRUISES



 **AVALON**
WATERWAYS®

CHART A COURSE LIKE NO OTHER WITH A ONE-OF-A-KIND AVALON CHARTER CRUISE.

It's hard to find a more immersive way to explore the world than on the great rivers that flow through the most iconic and inspirational destinations. And what better way to create inspiration and incentive for your special clients and guests than on an Avalon Charter cruise? Your exclusive and personalised charter cruise is designed as a reflection of you and your cruise companions with customised details in your signature style. Gather in thoughtfully appointed meeting spaces, complete with state-of-the-art equipment, including screens, projection, and microphones. And your guests never miss a beat with personalised content streaming on our in-room televisions. Your brand messaging and themes can also be presented via onboard amenities, from custom signage, keycards, and even cakes – just to name a few. Enjoy custom menu options and the choice of an all-inclusive drink package to entertain like a pro. Avalon can fully customise your charter itineraries to speak to your interests, with flexible sailing times and variable lengths of cruises to suit you perfectly.

TABLE OF CONTENTS

4	Charter & Incentive River Cruises	26	Avalon Suite Ships®
6	Panorama Suites SM	34	Where Avalon Sails
8	Open-Air Balcony SM	36	European Charter Itinerary Samples
10	Avalon Choice®	38	6 days or Less River Cruises
12	Active & Discovery Cruises SM	40	Southeast Asia River Cruises
16	Avalon Inclusions	44	Globus® Family Of Brands Lighthouse Project
18	Avalon Dining & Drinks	46	The Globus Family of Brands
22	On Board & On Shore Customisation		
24	Avalon Meeting Planning		









AVALON WATERWAYS CHARTER & INCENTIVE RIVER CRUISES

Avalon Waterways has been showing groups the world since 2004. From large sales organisations, to franchise groups, to meetings, events, affinity groups, and even friends and family, clients choose Avalon for the unmatched charter experience we deliver guests, and the intimate experience our ships deliver. A part of the Globus family of brands, a trusted travel provider for 95 years, Avalon is the expert in designing river cruises and itineraries across the world.

Our dedicated charter team provides unparalleled support and assistance throughout the entire process, from planning your cruise to ensuring the entire experience is a success beyond your expectations. You'll have an array of materials to promote your charter to your group to build excitement.

Our industry exclusive Suite Ship® fleet provides your entire group the opportunity for the same large suite style cabin accommodations. All charter and incentive river cruise itineraries and onshore excursions are fully customisable, so you can create the most unique and personalised trip for your group.

Navigating elegance and ease, our crew delivers an exclusive and personalised experience. From the Captain and Cruise Director to your stateroom attendant and waiting staff, Avalon provides warm and friendly service, mouthwatering cuisine, and unmatched experiences – to deliver the perfect degree of relaxed indulgence.

"Avalon Waterways delivers an exceptional European river experience for our corporate and incentive clients. Their ships are elegant. Cuisine and service provided on board their vessels are among the best in the industry. Our clients returned happy, wishing to repeat the experience."





OH HOW **SUITE** IT IS.

EVERYONE ENJOYS THE SAME STATEROOM &
THE SAME AMAZING VIEW.

There's only one point-of-view on an Avalon Waterways river cruise — the Suite view. You won't find the challenge of who to place in what cabin when choosing Avalon Waterways. Our unique Suite Ships® feature our signature Panorama SuitesSM with the widest opening windows in river cruising and beds facing the windows for your guests to enjoy what river cruising is all about — the ever changing views. On our Suite FleetSM in Europe, almost 80% of the staterooms are 200 square foot suites and in Southeast Asia, all rooms are Panorama Suites at a spacious 245 square feet.



**AT 200 SQUARE FEET, THE PANORAMA SUITESM IS MORE THAN
30% LARGER THAN THE INDUSTRY STANDARD.**



“Our stateroom was comfortable and attractive. People felt they had ample space and they loved the balcony windows. I was impressed with the strong water pressure in the shower and the L’Occitane toiletries smell wonderful...”

OPEN-AIR BALCONYSM

WIDER OPENINGS FOR THE WIDE-EYED.

Avalon Waterways Open-Air Balconies were designed with our guests' views in mind. The wall-to-wall, floor-to-ceiling windows open 7-feet wide on our European fleet and 11-feet wide on our Southeast Asia ships... Wider than any other balconies in the industry.

Even better? Avalon's balconies do not sacrifice room space. In contrast, they invite our guests to enjoy 100% of their Panorama Suite, 100% of the time. And they're making a splash with Avalon's guests. In fact, according to a survey of 652 past travellers, 95% would choose Avalon's Open-Air Balconies to traditional French balconies.

We're the only river cruise company that's figured out how to give our cruisers everything they want — more space, indoor/outdoor living, and huge views for miles in the comfort and privacy of their rooms.



THE LARGEST STANDARD WINDOWS IN RIVER CRUISING WITH
FLOOR-TO-CEILING, WALL-TO-WALL VIEWS.

AVALON

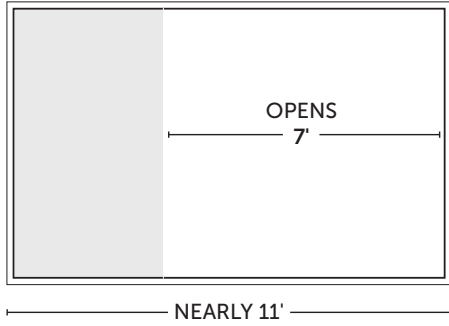

Our giant floor-to-ceiling window is nearly 11' wide.

THE COMPETITION

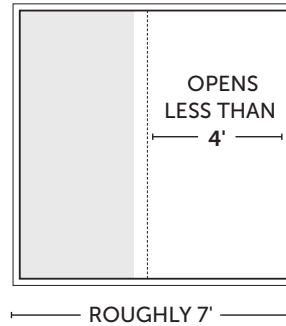

Standard window is roughly 7' wide, and opens less than 4'.





YOUR CRUISE. **YOUR WAY.**

EASY ON SHORE CUSTOMISATION WITH AVALON CHOICE

Our unique itineraries are not only fully customisable, they also include award-winning Avalon Choice excursions. We invite you to select the excursions and events that interest your party most, so your group can experience their cruise... their way. Excursion options feature opportunities to explore CLASSIC sights, make a new DISCOVERY through hands-on cultural and artistic experiences shared by local residents and experts, or to embark on an ACTIVE adventure. Each day your guests will get to choose from the Avalon Choice excursions you've selected and personalise their cruise to suit their interests and passions.

 **AVALON CHOICE**®



THE 3 TYPES OF AVALON CHOICE EXCURSIONS AVAILABLE ON EVERY CRUISE ARE:

CLASSIC

Your local expert is ready to guide you through the history and heritage of local destinations. You'll marvel at the legends, lore, and spectacular architecture of iconic and historic sites.

DISCOVERY

We've found inspiring and interactive activities to speak to your interests – from cooking classes, to painting workshops, to wine tastings and vineyard visits - to immerse yourself in each culture you explore.

ACTIVE

Embark on energetic excursions to keep you in motion and on the go – from biking or paddling, to hiking your way through scenic locales.

These and so much more, are available for customisation for your guests. The possibilities are endless, and the experience of chartering with Avalon Waterways is sure to provide onshore delights and memories your group is sure to continue talking about long after the return home.

“The shore excursions were very good. The guides were very passionate about their cities, extremely knowledgeable, and very personable. There was a good mix of escorted & narrated tour and free time. It was also wonderful when we could dock right in the centre of town.”

ACTIVE & DISCOVERY CRUISES

AN IMMERSIVE CRUISE EXPERIENCE.

Why just see the famous sights of the world when you can participate in each destination's unique experiences? With Avalon's Active & Discovery cruises, you choose how to experience the world! Spark your inspiration with cultural discoveries or elevate your heart rate with active excursions that immerse you in the culture, cuisine, and captivating views! Pull up a chair to hear a Vienna waltz, roll up your sleeves to paint like Van Gogh, or grab an apron to whip up a local speciality. Discover the world's simple pleasures and grand artistry, from famous galleries to farmhouse kitchens. Greet the day with a bike ride, a hike to a hilltop castle, or a kayak excursion on Europe's extraordinary waterways. Go from observing to doing on an Avalon Active & Discovery cruise.

After all, the adventure is up to you.



ACTIVE & DISCOVERYSM

EXPLORATION IN MOTION

For the traveller who thrives on motion and action, Avalon has created a broad menu of energetic excursions. You might find yourself on a hiking tour in a French vineyard, on a biking tour around Vienna, or even on a canoe trip on the Danube. From a climbing trip up to a medieval castle to hiking in the forest, these included excursions pack real get-up-and-go for those who like to do the same.

ENGAGING EXPERIENCES

For those who believe that life is about trying new things, Avalon presents an inspiring selection of interactive excursions created for the different kind of “doer.” These hands-on experiences include a painting class in Amsterdam, tasting locally produced cheese and beer at an ancient abbey, or saying “good morning” to Vienna on an early-riser walk to a quaint café for breakfast like a local. Traditions come to life as you shift from observer to participant in a variety of creative and engaging endeavors.



ACTIVE & DISCOVERY CRUISES THROUGH EUROPE



ACTIVE & DISCOVERY ON THE RHÔNE

8 days | Lyon to Arles (or reverse)

In addition to classic sightseeing and relaxed free time, take an active approach with a visit to an oyster farm or a bike ride through Camargue Regional Nature Park to spot flamingos, Discover hidden talents with a painting workshop in Arles—in the style of Van Gogh. Feel free to mix it up with a balance of active and discovery styles. Take a kayak excursion or linger in a corner café, stroll Avignon's papal palace or attend a wine tasting in an underground cave. Admire the lovely views of the French countryside, or join a culinary walk to discover architecture and local specialities, or take a cooking class in Lyon. With so many included choices, you'll find the perfect way to spend your day—from a ghost tour in Viviers to a guided bike ride through the Gard region, to a chocolate factory tour.



ACTIVE & DISCOVERY ON THE RHINE

8 days | Amsterdam to Basel (or reverse)

Your Active & Discovery Rhine River cruise begins in Amsterdam for a day full of activities. See the colourful corners of Amsterdam your way with your choice of active exploration to local discoveries—from a canal cruise to a leisurely biking tour—all at an easy pace! You might choose an included painting class, instead, to recreate the masterpieces of Dutch artists. Visit the Chocolate Museum in Cologne, take a guided “bites and highlights” tour in Düsseldorf, and taste regional wines in Eltville. In Koblenz, take a cable-car ride up to Ehrenbreitstein Fortress for magnificent views of the surrounding area. Sail through the magnificent Rhine Gorge and enjoy speciality dishes while cruising. Join us for an Active & Discovery Rhine River Cruise with more included selections for every preference, passion, and pace.



ACTIVE & DISCOVERY IN HOLLAND & BELGIUM

8 days | Amsterdam to Amsterdam

Begin in Amsterdam and sail for Middelburg for a variety of Classic to Active to Discovery included excursions. Continue to Belgium and marvel at the artistry and natural beauty of the region. In Brussels, walk the ancient streets and sample treats at a Belgian chocolate-making workshop. Explore by bike or take a guided tour! In Antwerp, discover centuries of history. Experience the Red Star Line Museum where brave emigrants boarded ocean liners for America long ago, or see the stunning altarpiece by master painter Rubens in the cathedral there. Take an architecture tour by bicycle through Rotterdam or create a classic Delft tile in a pottery workshop. Return to Amsterdam to enjoy the colourful city of canals. Take a painting class, ride a bike through the Dutch countryside, or relax on a canal cruise through the grachten of this city of a Golden Age.



ACTIVE & DISCOVERY ON THE DANUBE

8 days | Vilshofen to Budapest (or reverse)

Whether you're an art lover, a foodie, a history buff, or an energetic adventurer, your Active & Discovery cruise on the Danube River offers just-right included activities and excursions to suit your interests. Whether you prefer browsing the art collection of the Habsburg Empire, sipping local vintages at an Austrian wine tasting, or joining a canoe excursion, your Active & Discovery Danube River cruise is packed with Avalon Choice® inclusions for every preference and pace in every place we go. Whether you prefer classic sightseeing with an expert Local Guide, an active excursion by bike, hike, or canoe, or a creative experience in culinary or performing arts, you'll find the perfect way to spend your day. Sample cheese and beer made by Trappist monks and explore their Abbey gardens. Choose an insider's tour of Vienna, or join a canoe excursion—your Active & Discovery river cruise has something for every interest. From a wine tasting to a hike to Count Dracula's prison tower, to a visit to Belvedere Palace in Vienna to see Klimt's renowned “The Kiss,” to a Medieval Knights Tournament at a Visegrád castle.



ACTIVE & DISCOVERY ON THE SEINE

8 days | Paris to Le Havre (or reverse)

Begin your French river cruise on the Seine in Paris—"The City of Light." Discover the true heart of Paris on a guided walk through the sites of Paris, or actively explore the city by bike or a walking food tour. Cruise to Conflans and choose between an excursion to visit Auvers-sur-Oise or Napoleon and Josephine's Château de Malmaison. Perhaps join an e-bike tour to the Château de Maisons-Lafitte or learn how to prepare a Chantilly cream. In Vernon enjoy a food walking tour or experience the city by bike. Sail on to Les Andelys for plenty of choices, from a guided tour to a hike experience or a visit to Lyons-la-Forêt. Continue to Rouen for a walking tour of the village. Alternatively, enjoy a guided kayak tour. You'll cruise to Caudebec for an excursion to Normandy. Choose from a selection of excursions, including a tour of the WWII landing beaches at Normandy, or a "Taste of Normandy" tour to taste the farming traditions and culinary specialties of this area. The last stop is Le Havre, where you can choose between a city sightseeing, a bike tour or a visit to the Palais Bénédicte in Fécamp.



ACTIVE & DISCOVERY ON THE LOWER DANUBE

7 days | Oltenita to Osijek

Embark on your Suite Ship® in the town of Oltenita and cruise for Nikopol. See the incredible ancient architecture in Veliko Târnovo or hike to the Kroushuna Waterfalls. Sail to Vidin, Bulgaria, explore the city and visit the medieval Fortress. Cruise through the Iron Gates Gorge, explore the amazing archaeological site of Lepenski Vir, and visit the Fortress of Golubač. Sail to Belgrade, Serbia, where the Danube and Sava Rivers meet. Sail into beautiful Croatia, where a 1,000-year-old winemaking tradition lives on in Ilok. Disembark in Osijek.



ACTIVE & DISCOVERY ON THE MOSELLE

8 days | Remich to Frankfurt

Board your Avalon Suite Ship® in Remich to explore with both active excursions and authentic discoveries. An excursion to historical Luxembourg City offers unique and dramatic views, as the town is set on two levels—high above on straddling hills and dropping into two river valleys. Consider a canoe excursion on the Moselle or a visit to Schengen with a tasting of local products. Enjoy a guided walk in the charming wine village of Berncastel and taste some of the region's best wines. Continue on the Moselle River to the picturesque town of Cochem where the Riesling grape is cultivated. Visit Reichsburg Castle, nestled among vineyards above the river valley below. Enjoy a guided walk or visit a local brewer in Koblenz. Sail into the Rhine River to the Rhine valley town of Rudesheim. Discover the Mechanical Musical Instruments Museum, and stroll through the town's famous cobblestone Drosselgasse. Your river cruise holiday ends in Frankfurt, where you may join a guided sightseeing tour of the city, visit the Frankenstein castle, or bike along the Main and Nidda Rivers.



ACTIVE & DISCOVERY ON THE DANUBE FROM CROATIA TO THE BLACK SEA

7 days | Osijek to Fetesti

Board your Avalon Suite Ship® bound for Belgrade, Serbia. Here, explore the city where the Danube and Sava Rivers meet with a guided bike tour. Cruise through the Iron Gates Gorge. Visit the amazing archaeological site of Lepenski Vir. Sail to Vidin, Bulgaria, explore the city and visit the medieval Baba Vida Fortress. See the incredible ancient architecture in Veliko Târnovo and Arbanassi, or join your local guide for a hike. Take a guided tour of Constanta or join a delicious food tour. Disembark in Fetesti.

EXCLUSIVE MEETS **INCLUSIVE.**

What's included beyond a flawlessly planned itinerary for your guests — everything. In our quest to make every guest feel perfectly at home, we include the features — both big and small — that make your cruise with us as rich as possible. An exclusive experience features all the right inclusions, yet still leaves room for personalisation. In addition to little luxuries like complimentary Wi-Fi and around-the-clock cappuccinos, Avalon gives you the greatest luxury of all — the freedom to customise your charter with endless options.





ALWAYS INCLUDED ON AVALON WATERWAYS CHARTERS:

- AVALON CHOICE® included sightseeing with Certified Local Guides, Guided Optional Excursions and Tours, and ample free time to explore on your own. Explore CLASSIC sights, embark on ACTIVE excursions, and make a new DISCOVERY through hands-on cultural and artistic experiences shared by local residents and experts.
- All meals and snacks served on board including: full breakfast, lunch, afternoon coffee/tea/cake, dinner
- Complimentary in room dining available for breakfast and dinner
- Afternoon Sky Grill lunch on the Sky Deck (weather permitting)
- Complimentary picnic lunches available to guests for independent sightseeing in port
- Complimentary regional wines and beers or soft drinks served with lunch and dinner. Sparkling wine served with breakfast.
- Free house beer, wine, spirits, as well as a featured cocktail of the day at Happy Hour
- Complimentary speciality coffees, tea, hot chocolate, juices and vitamin enhanced waters in the Club Lounge.
- Welcome reception and Gala dinner
- Port lectures, educational commentary, and other activities delivered by your professional Cruise Director
- Local entertainment and some nights in port (see itinerary for details)
- Complimentary Wi-Fi
- Complimentary AvalonGo mobile app for guest's personal devices offering port information, GPS enabled maps, access to the Daily Newsletter and menus (AvalonGo app can be customised).
- Avalon Adventure Centre and Adventure Host with all the active gear guests need for their free time ashore including complimentary bicycles, e-bicycles, Nordic walking sticks, picnic blankets, binoculars, backpacks and much more!
- Meeting space with custom configurations available
- Audio/visual equipment including screens, projector and microphones
- Customised/branded materials including signage, banners, flags, napkins, cakes and a variety of other items
- In room TV programming customisable with your message





"The meals were absolutely delicious. Seriously good...The daily variety and quality of all the food was excellent and thoroughly appreciated. And it was so nice to be able to have a Caesar salad or steak & potato on the day when comfort food was desired. Hats off to the entire kitchen staff."



EVERY MEAL IS PART OF THE JOURNEY.

YOUR DINING EXPERIENCE

From morning breakfast to elegant dinners, Avalon frees your taste buds from the ordinary. Choose the onboard dining venue that suits your mood — from a breezy al fresco lunch at the Sky Grill to an elegant four-course dinner in the glass-walled dining room. For a less formal “sit-down” atmosphere, guests can take a more casual approach to fine dining while mingling over satisfying selections in our Panorama Bistro. Whichever venue your guests choose, they’ll savour local flavours and the familiar favourites you may crave — as well as our Avalon Fresh® menu options — throughout your cruise.

ONBOARD DINING OFFERINGS & CHOICES:

- Welcome & farewell receptions with sparkling wine & canapés
- Daily choices of regional recipes, familiar favourites, and Avalon Fresh® vegetarian and healthy cuisine including fresh, local ingredients at every meal
- Daily full breakfast with made-to-order egg station, hot and cold menu items, and complimentary sparkling wine & juices
- Daily lunch with pasta & carving stations and complimentary beer, wine, and soft drinks
- Choice of alternative fare at the Sky Grill on the Sky Deck (weather permitting) or light lunch in the Panorama Lounge
- Enjoy our Panorama Bistro for a casual dinner option with select dishes and beverages
- Daily Afternoon Tea featuring tea, coffee, sweet treats & sandwiches
- Free house beer, wine, spirits, as well as a featured cocktail of the day at Happy Hour
- Daily four-course à la carte dinners in the main dining room with choice of appetizers, soups, salads, entrées, desserts or cheese, after-dinner premium coffees or tea, and complimentary wine (including from the region), beer, and soft drinks
- Complimentary room service available for breakfast and dinner
- FlexDining® with flexible seating-times to better accommodate your schedule
- Made-to-order picnic lunch boxes for independent onshore excursions
- Special dietary options upon request

DRINK PACKAGES:

For charters, if you’d like to include cocktail parties or an all-inclusive beverage package, we can provide options to design the best offering for your guests.

LOCAL. HEALTHY. **AVALON FRESH**®

Who says healthy cuisine can't be inspiring? On an Avalon Waterways river cruise, you can take an indulgent holiday without drifting from your healthy habits. Our Avalon Fresh selections are exclusively created in collaboration with Austrian brothers Leo and Karl Wrenkh, leading chefs in the healthy-dining movement. Using the freshest ingredients from local farms and suppliers, our chefs create flavourful dishes with a dash of innovation. These creative yet wholesome options are available at every meal we serve on board. Whether you're looking for an energising juice at breakfast, an artfully crafted salad at lunch, or a satisfying plate at dinner, Avalon Fresh steps up to the plate with the perfect ingredients to fuel your day.



AVALON FRESHSM



THE PERFECT PAIRING

Brothers Karl and Leo Wrenkh—two of Europe’s rising culinary stars—have partnered with Avalon to present the latest concept in “haute cuisine.” With the addition of Avalon Fresh®, travellers can guiltlessly indulge in a mouthwatering menu that combines the freshest ingredients with surprising flavours and a dash of innovation. With the philosophy of procuring ingredients from small farms and local producers, the Wrenkh brothers bring the passing landscape to the plate for an inspiring, fulfilling, and healthful dining experience.

THE LIBATIONS YOU’LL LOVE

Linger over signature cocktails and standard concoctions with a twist. Toast your adventures with the original Espresso Martini or Easy Stinger — just two of our craft cocktails designed by Avalon’s award-winning mixologist, Martin Hudák. Raise your glass and lift your spirits with your choice of remarkable refreshments in our Panorama Lounge.

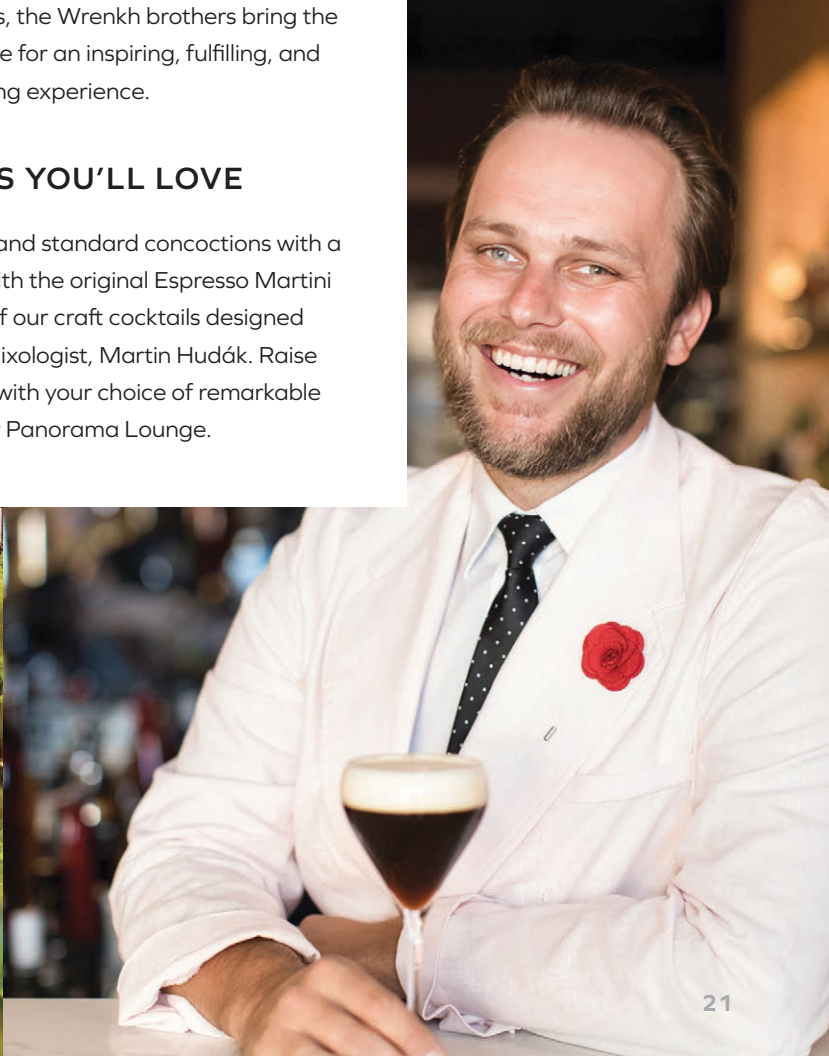

CUSTOMISATION IS WELCOME HERE, ON BOARD & ON SHORE.

YOU DREAM IT. WE'LL DELIVER IT.

Looking for something unexpected and unique? Our passion is ensuring you and your guests are delighted through the planning process to cruise end. We can fully customise your charter itinerary, and offer the opportunity for exclusive excursions and onboard events personalised for your group.

With Avalon Waterways, you have choices. From where to sail, how long to sail, where to port, to the number of activities and onshore events, we make the cruise personalised for you. Not sure what is best? We'll help make the process seamless, building an itinerary that makes it easy for you to pick and choose what activities and destinations will leave your guests enchanted.



OPTIONS TO CREATE THE PERFECT CRUISE ITINERARY FOR YOUR GUESTS.

- Customisable Ports
- Flexible Sailing Times
- Variable Length of Cruise
- Onshore Activities
- Exclusive Galas & Events
- Pre-and post cruise land stays
- Tandem and multi-ship charter itineraries available for larger groups
- Flexible meeting space with audio/visual
- Customised menu options
- Customisable signage, key cards, banners, flags, etc.

“I have had the pleasure of working with Avalon Waterways for many years on incentive group and charter voyages... Avalon is consistently exceptional. One of the primary reasons for success is the willingness to adapt, create, and deliver out of the box ideas to make river cruising a unique and customised experience.”



WORK TO PLAY. DAY TO NIGHT. **ALL YOUR WAY.**

Avalon Waterways has you covered handling all the details in perfectly executing successful events day and night, from meeting planning to evening entertainment for your guests.

“My experience with Avalon from the initial booking process to the planning and operation was virtually flawless. The onboard accommodations, food and beverage and tours exceeded client expectations, but the professional and friendly staff really made the difference.”

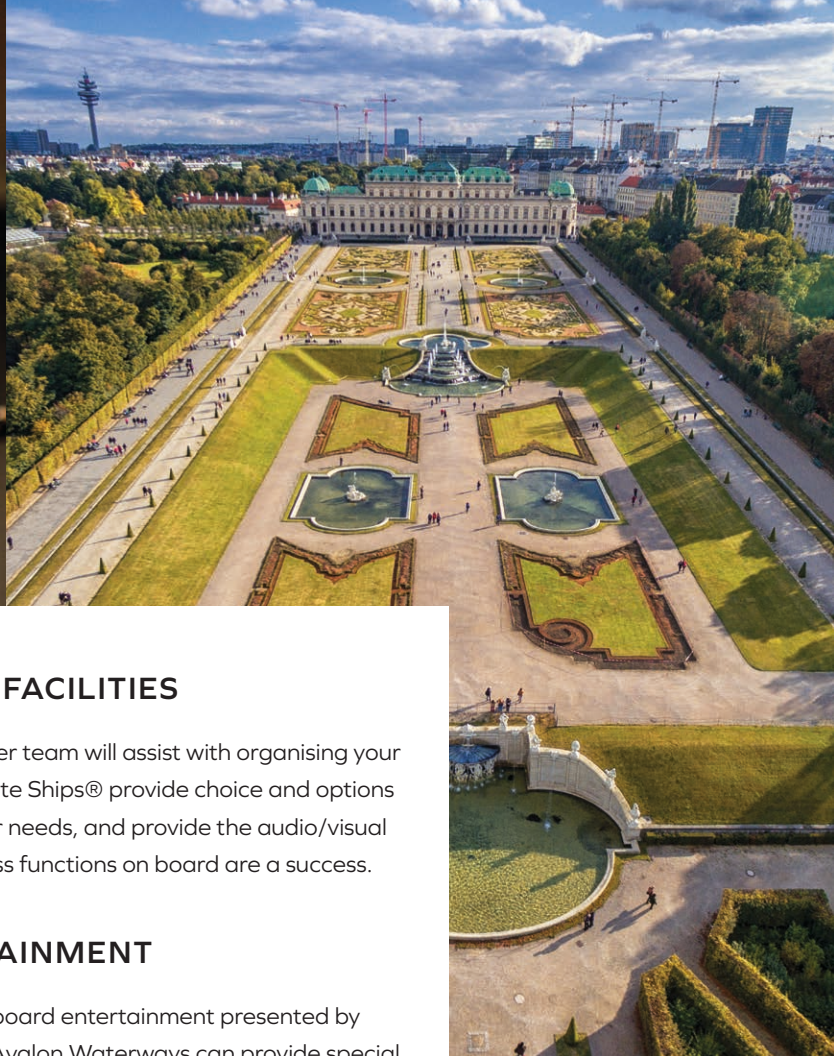

MEETING FACILITIES

Avalon Waterways dedicated charter team will assist with organising your meeting or group functions. Our Suite Ships® provide choice and options on venue space depending on your needs, and provide the audio/visual equipment to ensure your business functions on board are a success.

ENTERTAINMENT

In addition to our scheduled on board entertainment presented by entertainers, artisans and experts, Avalon Waterways can provide special onboard and onshore experiences, custom designed to enrich your cruise and travel experience.

GALA EVENTS

We will plan and organise the perfect, fully customisable gala dinner and event for your group. Step off the ship and enjoy the culture of one of the port towns in an unexpected and memorable way. From dining in castles and museums, to a party in Paris under the lights of the Eiffel Tower, we will make your event a remarkable experience for your guests.



OTHER AMENITIES:

- Elevator in Europe
- Non-smoking interior
- Complimentary water stations for 24/7 refills
- English-speaking TV channels with over 50 free movie options

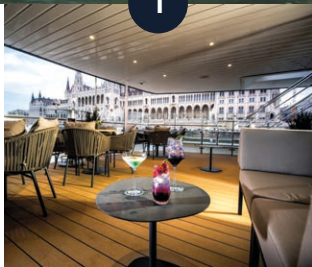

Observation Lounge

Breathe in the peaceful space and perfect vantage point on the river while relaxing in our Observation Lounge. Stretch out with coffee, wine, or whatever you please to watch the scenic shorelines, hills, and valleys.



Panorama Bistro

The ideal spot for a casual dinner in a social setting to mingle with your travelling companions and fellow Avalon guests. Enjoy petite plates of delicious dishes and beverages.



Panorama Lounge & Bar

Enjoy cosy seating, panoramic windows, and a dance floor to enjoy the evening's entertainment or unique artisan demonstrations. Visit the Panorama Bar for your favourite libation—or to try something new by our creative mixologists.



Sky Deck

The perfect place to take in the sights of the passing landscape or mingle with fellow travellers. Features a whirlpool and seating galore to soak up the sun or drink in the moonlight. In Portugal, the Alegria offers a swimming pool instead of a whirlpool. Bring your appetite to the Sky Grill for made-to-order lunch dishes to enjoy as you watch the world go by.



SMALL DETAILS. BIG DIFFERENCE.

Avalon Waterways provides the perfect setting for any successful event. Our European Suite Ships® atmosphere seamlessly blends relaxation and casual luxury into what guests' experience on board. Your group deserves the best of everything.



Dining Room

From morning breakfast to elegant dinners, Avalon frees your taste buds from the ordinary. In this glass-walled dining room, you'll savour local flavours (and familiar favourites, should you crave them) as well as our Avalon Fresh® menu offerings. Every meal is a part of the journey.



Adventure Centre

Find the gear, maps, and more for active pursuits on ship and off. Check out a bike, grab a Nordic walking stick and head up to a fortress on a hill, or join a guided jog. Whether you're looking for a yoga class on deck or an optional canoe excursion, your Avalon Adventure HostSM can make it happen.



Fitness Centre

Just because you've gone on holiday, doesn't mean your fitness regimen has to. Visit our fully equipped Fitness Centre for a great workout on your schedule. Get your cross training in with a bike, treadmill, and weights.



Club Lounge

Our beautiful airy and open lounge features a 24-hour self-service beverage station offering complimentary coffee, decaffeinated coffee specialities, cappuccinos, lattes, hot chocolate, and a selection of teas. Cookies, dried fruit and nuts are available throughout the day, as well as fresh water stations and vitamin water.

YOUR SHIP HAS COME IN. AVALON EUROPE SUITE SHIP®

DECK PLAN

- 1 Sky Lounge
- 2 Navigation Bridge
- 3 Sky Grill
- 4 Whirlpool
- 5 Premium Lounge Chairs and Shade Awnings
- 6 Deck Game Area
- 7 Observation Lounge
- 8 Panorama Bistro
- 9 Panorama Lounge
- 10 Bar
- 11 Reception
- 12 Adventure Centre
- 13 Lobby
- 14 Elevator
- 15 Club Lounge
- 16 Galley
- 17 Dining Room
- 18 Fitness Centre

CATEGORIES

- Royal Suite** Royal Deck | Royal Suites
- Cat. P** Royal Deck | Panorama Suites
- Cat. A** Sapphire Deck Forward | Panorama Suites
- Cat. B** Sapphire Deck Aft | Panorama Suites
- Cat. D** Indigo Deck Aft | Deluxe Staterooms
- Cat. E** Indigo Deck Forward | Deluxe Staterooms

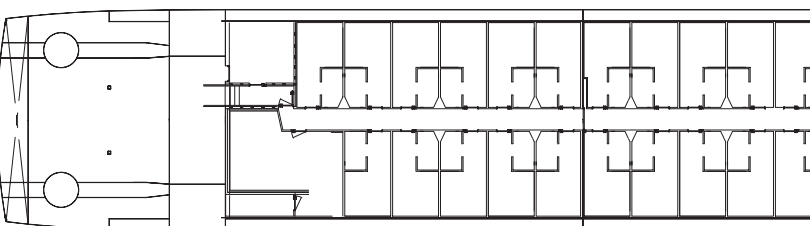
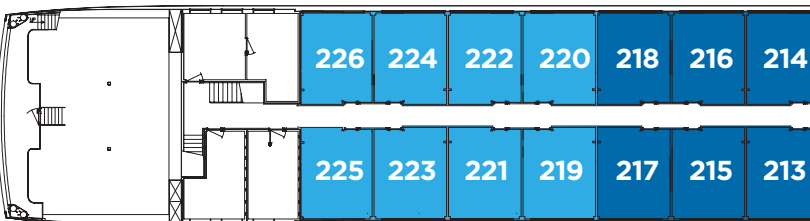
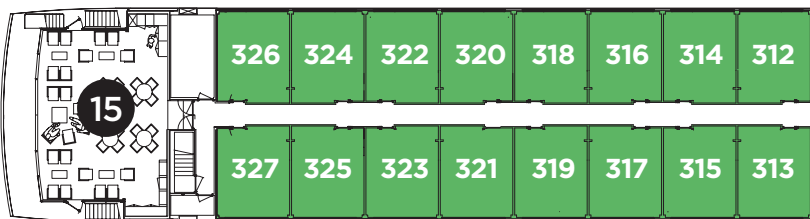
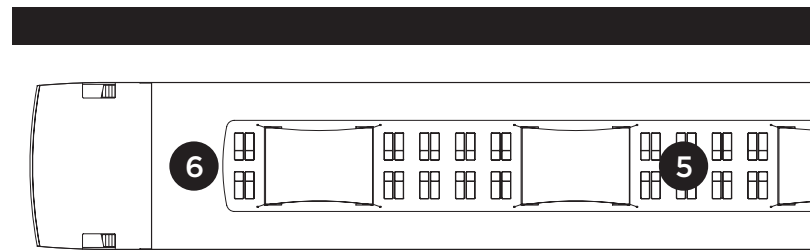
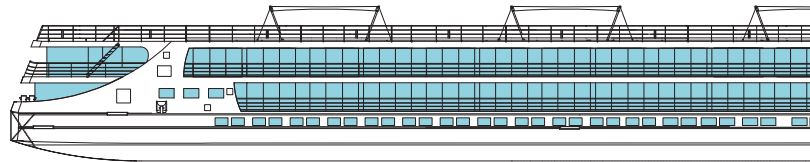

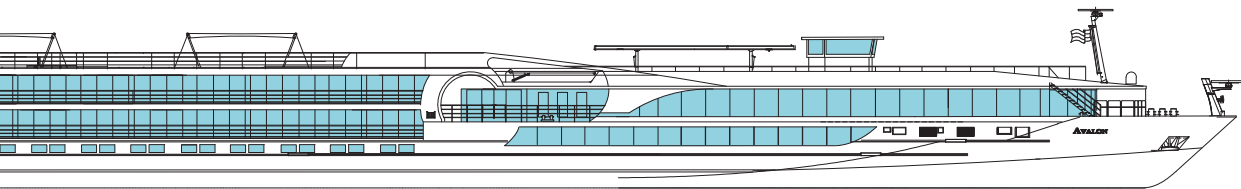

SKY DECK

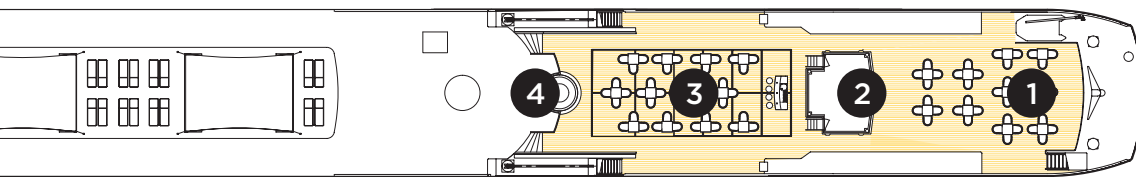

ROYAL DECK

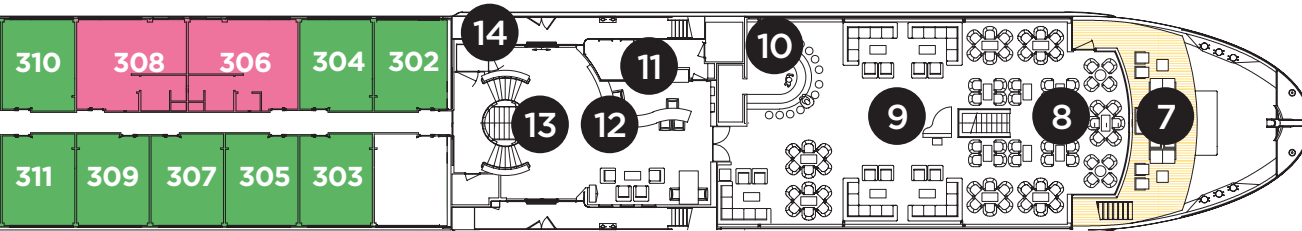

SAPPHIRE DECK

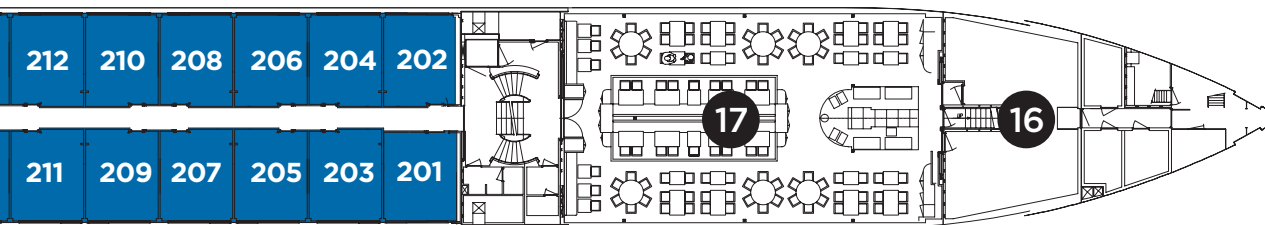

INDIGO DECK

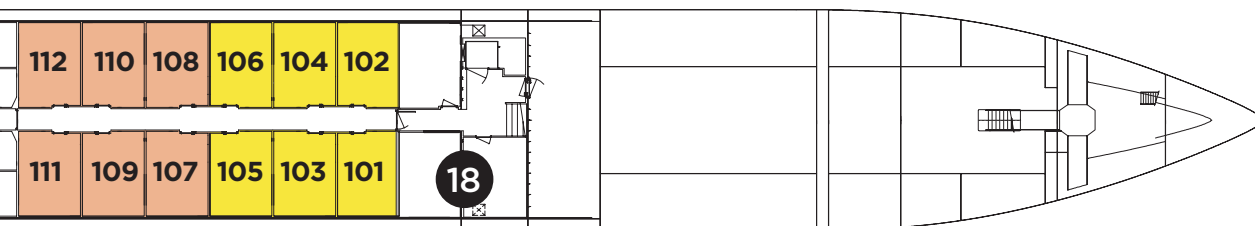

THE ART OF MAKING YOU FEEL AT HOME.

STATEROOM AMENITIES

- Comfort Collection BedsSM, featuring premium memory foam mattress toppers with special construction for increased airflow and ventilation and a choice of four firmness selections – from extra firm to pillow-top soft
- Egyptian super-combed cotton linens, blankets, & European-style duvets
- Soft & firm pillows
- Choice of bed configuration – two twins or one queen or (Royal Suite only) one king
- Nightly turn-down service
- Bathrobes & slippers in all staterooms
- Bedside tables with reading lamps
- Large private bathroom featuring full shower with glass door, hairdryer, & premium L'Occitane® amenities and plenty of storage
- Spacious 3-door closets with shelves for ample storage
- Easy under-bed luggage storage
- Flatscreen satellite TV with movie channels
- Writing desk/vanity with mirror & comfortable chair
- Complimentary Wi-Fi access
- Direct-dial telephone
- Well-stocked minibar
- Complimentary filtered water refreshed daily
- USB Ports
- In-room safe
- Individual climate control

ROYAL SUITES

300 SQ. FT.
ROYAL DECK

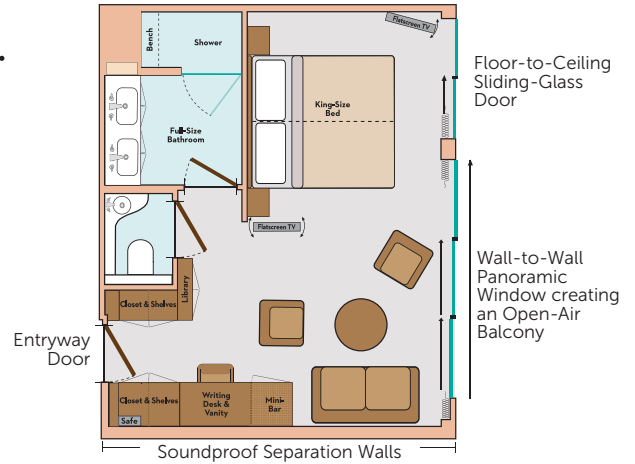

PANORAMA SUITESSM

200 SQ. FT.
ROYAL & SAPPHIRE DECKS
Category B, A, P

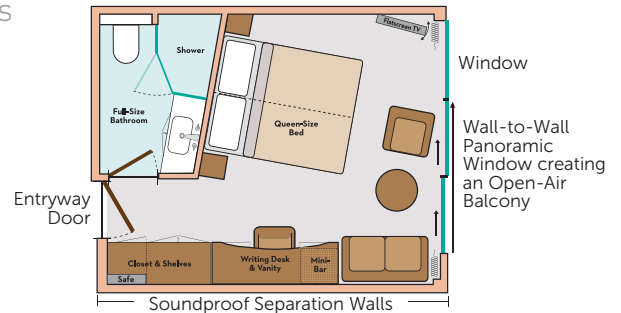

DELUXE STATEROOMS

172 SQ. FT.
INDIGO DECK
Category D & E

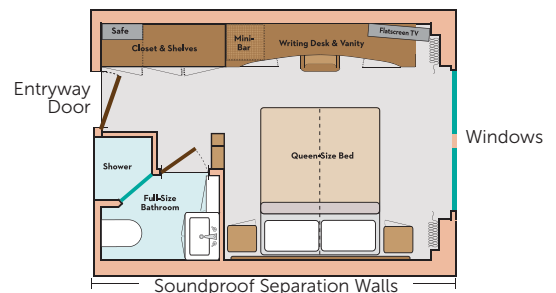

TAKE A VIRTUAL TOUR OF OUR SUITE SHIPS AT
WWW.AVALONWATERWAYS.CO.UK/WHY-AVALON/VIRTUAL-TOUR/



CRUISING ON **THE DOURO RIVER**

AVALON ALEGRIASM (2024)

Passengers: 102 | Crew Members: 33 | Length: 262 ft. | Decks: 4. | Deluxe Staterooms: 14 (172 & 180 sq. ft.) | Panorama Suites: 37 (200 sq. ft.)



AMENITIES

- Complimentary Wi-Fi throughout the ship
- Panoramic windows throughout the ship
- Elegant, contemporary design & decor
- Friendly, English-speaking crew & Cruise Director
- Sky Deck features swimming pool, shade awnings, and premium lounges)
- Covered Observation Lounge
- Club Lounge with 24-hour self-serve beverage station with complimentary cappuccinos, lattes, tea, hot chocolate & premium coffees, as well as treats throughout the day
- Elevator
- Non-smoking interior and staterooms
- Active shore excursions, both included and optional
- Fitness Centre
- Avalon Adventure Centre

AVALON ALEGRIA

DECK PLAN

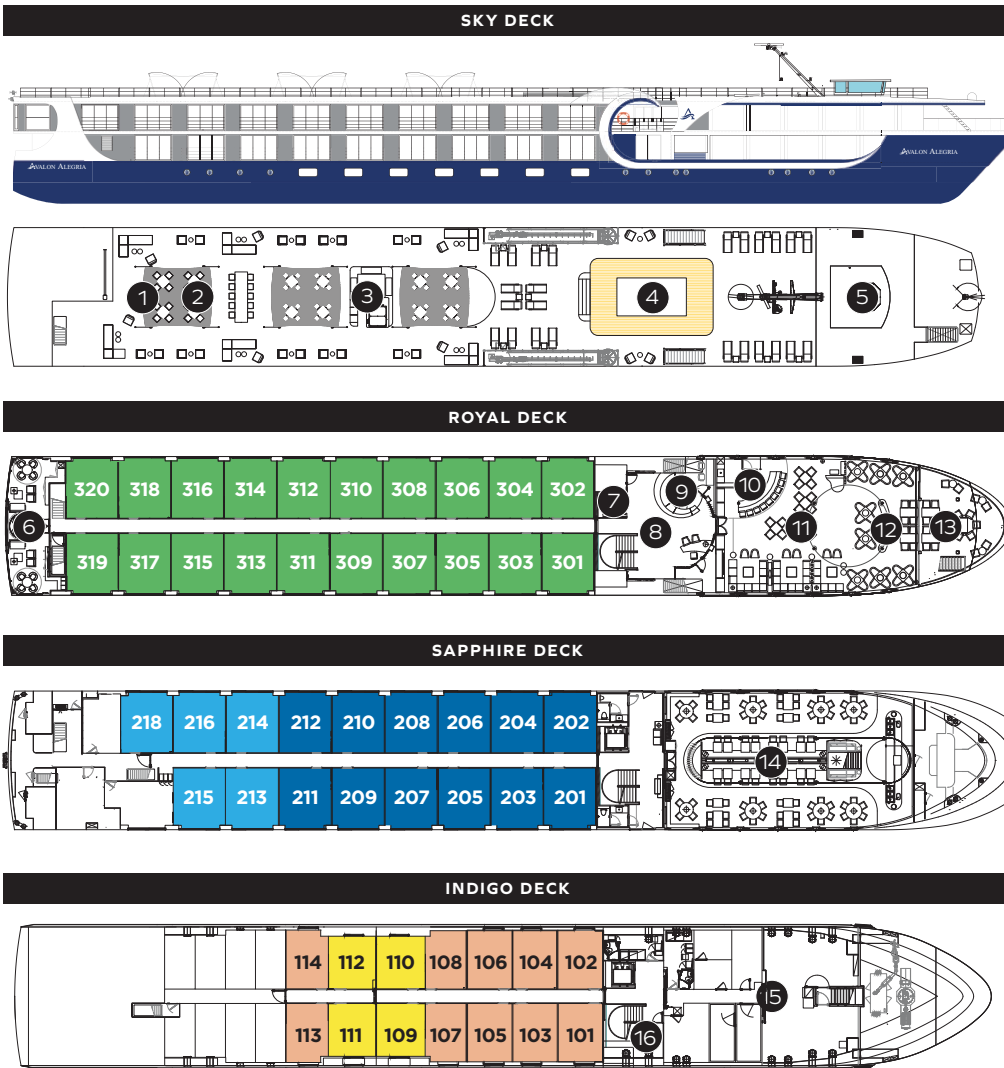

DECK PLAN

- 1 Sky Lounge
- 2 Premium Lounge Chairs and Shade Awnings
- 3 Sky Grill
- 4 Pool
- 5 Navigation Bridge
- 6 Club Lounge
- 7 Elevator
- 8 Adventure Centre
- 9 Guest Services
- 10 Bar
- 11 Panorama Lounge
- 12 Panorama Bistro
- 13 Observation Lounge
- 14 Dining Room
- 15 Galley
- 16 Fitness Centre

CATEGORIES

- Cat. P** Royal Deck | Panorama Suites
- Cat. A** Sapphire Deck Forward | Panorama Suites
- Cat. B** Sapphire Deck Aft | Panorama Suites
- Cat. D** Indigo Deck | Deluxe Staterooms
- Cat. E** Indigo Deck | Deluxe Staterooms

CATEGORY E DELUXE STATEROOM

172 SQ. FT.

INDIGO DECK

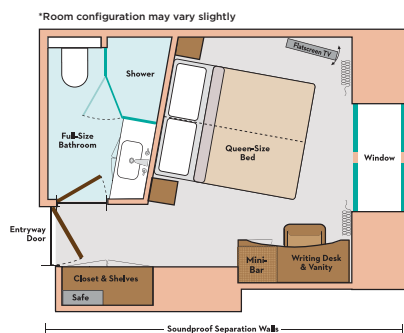

CATEGORY D DELUXE STATEROOM

180 SQ. FT.

INDIGO DECK

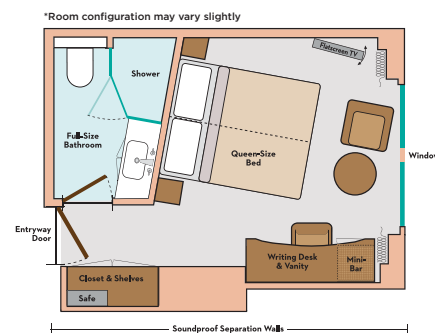

PANORAMA SUITE

200 SQ. FT.

ROYAL & SAPPHIRE DECK

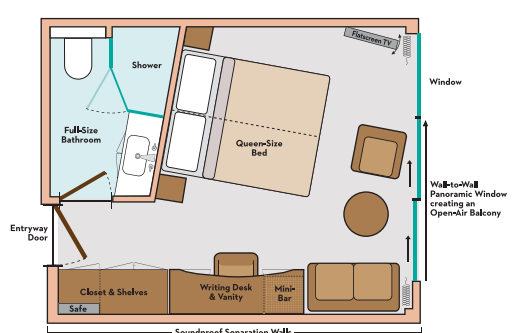

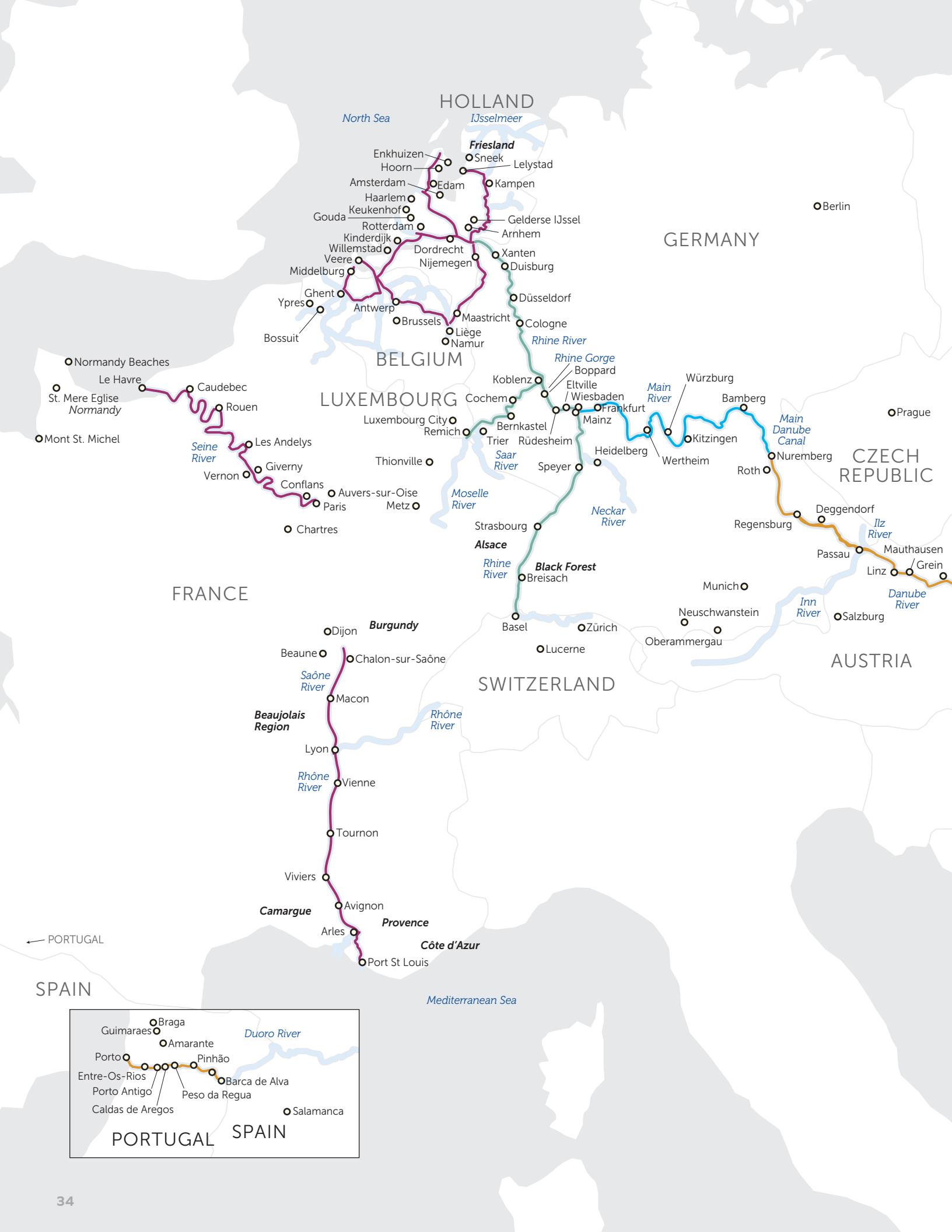

WHERE AVALON SAILS

RHINE RIVER

Flowing from the Swiss Alps to Holland's North Sea, the Rhine is one of the most important rivers in Europe, perhaps most famous for its legendary Lorelei rock and the imposing medieval castles that line its banks.

MAIN RIVER

Winding across Central Germany, the Main River is formed by the joining of the Red Main and the White Main, meeting the Rhine River at the town of Mainz.

MOSELLE RIVER

Flowing through France, Luxembourg, and Germany, the Moselle River is known for the excellent wines produced along its banks as well as for its picturesque medieval castles.

SEINE RIVER

The Seine rises just northwest of Dijon and flows in a northwesterly direction through Paris before emptying into the English Channel at Le Havre. It is one of Europe's great historic rivers and since the early Middle Ages has been considered the river of Paris.

RHÔNE RIVER

An important inland trade and transportation route since Greek times, the Rhône River flows south to the Mediterranean, winding through the orchards and vineyards of the fertile Rhône Valley.

DANUBE RIVER

As Europe's second-longest river and a vital means of transportation for 2,000 years, the Danube is the only major European river to flow from west to east.

DOURO RIVER

Here, vineyards cling to steep slopes along the river where 2,000-year-old traditions of winemaking are cherished in the charming villages in one of Europe's oldest countries.





A SAMPLING OF OUR MOST POPULAR EUROPEAN CHARTER ITINERARIES:

A TASTE OF THE DANUBE

4 days | Budapest to Vienna (and reverse)

Budapest – Bratislava – Melk – Wachau Valley –
Dürnstein – Vienna

DANUBE SYMPHONY

6 days | Vilshofen to Budapest (and reverse)

Vilshofen – Linz – Mauthausen – Ybbs – Wachau
Valley – Krems – Vienna – Bratislava – Budapest



ROMANTIC RHINE



BUDAPEST



DÜRNSTEIN



PARIS

DANUBE DREAMS

8 days | Vilshofen to Budapest (and reverse)

Vilshofen – Passau – Linz – Ybbs – Melk – Wachau Valley – Durnstein – Vienna – Bratislava – Budapest

ROMANTIC RHINE

8 days | Amsterdam to Basel (and reverse)

Amsterdam – Cologne – Rhine Gorge – Rudesheim – Mainz – Heidelberg – Strasbourg – Breisach – Basel

PARIS TO NORMANDY

8 days | Paris to Paris

Paris – Vernon – Les Andelys – Caudebec (Normandy Beaches) – Rouen – Conflans – Paris

BURGUNDY & PROVENCE

8 days | Chalon-sur-Saône to Arles (and reverse)

Chalon-sur-Saône – Mâcon – Lyon – Tournon – Viviers – Avignon – Arles

SHORT & SUITE. THE BEST CRUISES FOR LIMITED SCHEDULES

Short on time but big on dreams? Choose the perfect cruise to fit your schedule on the Rhine, Danube, and Main Rivers. Choose from Avalon's best European river cruise destinations itineraries — just 6 days or less — for the length of time that's perfect for you.



HERE'S A SAMPLING:

A TASTE OF THE DANUBE

4 days | Budapest to Vienna (& reverse)

Budapest – Bratislava – Melk –
Wachau Valley – Dürnstein – Vienna

THE BEST OF THE RHINE

5 days | Frankfurt to Basel

Frankfurt – Rhine Gorge – Strasbourg – Breisach – Basel

CHRISTMASTIME IN ALSACE & GERMANY

5 days | Frankfurt to Basel

Frankfurt – Speyer – Heidelberg – Strasbourg –
Breisach – Basel

DANUBE SYMPHONY

6 days | Vilshofen to Budapest (& reverse)

Vilshofen – Linz – Mauthausen – Ybbs – Wachau Valley –
Krems – Vienna – Bratislava – Budapest



SOUTHEAST ASIA: INTIMATE CRUISING AT ITS BEST.

Avalon river cruises go beyond expectations. They go beyond the grand waterways of Europe, too, winding down the intriguing waters of the Mekong in Southeast Asia. Our incredible Suite Ship® along the Mekong River carries just 36 guests for a more exclusive experience. Gliding through narrow passageways, this intimate ship gets travellers up close to these exotic sights, cultures, and traditions, and this smaller vessel leads you to areas virtually untouched by tourists. Personalised touches abound throughout your cruise.



THE MEKONG RIVER

Pulsing through the heart of Vietnam and Cambodia, the Mekong River provides a lifeline for millions of people. Along this vibrant “Mother of Water,” scenes of everyday life will mesmerise you — from fishermen hauling in their daily catch to chanting monks to boats crisscrossing the river. Cruise the massive Mekong Delta, meet with smiling schoolchildren, see skilled silversmiths at work, and partake in a traditional water blessing ceremony with area monks. Explore French-influenced Phnom Penh, take a walking tour of Ho Chi Minh City, marvel at spectacular Angkor Wat in Siem Reap, and relish other fascinating activities.



**POPULAR SOUTHEAST ASIA
CHARTER ITINERARY:**

**FASCINATING VIETNAM, CAMBODIA
AND THE MEKONG RIVER**

13 days | from Siem Reap to Ho Chi Minh City (and reverse)

Siem Reap – Phnom Penh – Wat Hanchey – Angkor Ban –
Kampong Tralach – Konpong Louang – Chau Doc – Long Khanh
A – Cu Lao Gieng – Vinh Long – Ho Chi Minh City





AVALON SAIGONSM

DECK PLAN

- 1 Open-air observation lounge with premium lounge chairs
- 2 Panorama Lounge
- 3 Bar
- 4 Reception
- 5 Spa treatment room
- 6 Dining Room
- 7 Galley
- 8 Navigation Bridge
- 9 Fitness Centre

LEGEND

- Cat. A** Tonle Deck | Panorama Suites
- Cat. B** Mekong Deck | Panorama Suites

SIDE VIEW

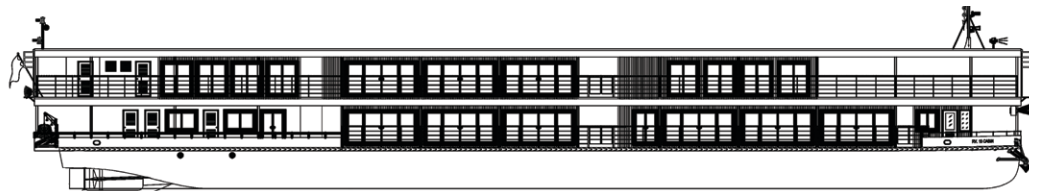

TONLE DECK



MEKONG DECK



FEATURES

- Capacity: 36
- Air-conditioned Panorama Lounge
- Open-air observation lounge with shade system & premium lounge chairs
- Spacious, open-seating dining room
- Bar serving premium spirits, wine, complimentary coffee, tea, soft drinks, and local beer/spirits throughout the day
- Complimentary Wi-Fi access in lounge areas (where signal is available)
- Spa treatment room
- Fitness Room
- Library & games



PANORAMA SUITES

245 SQ. FT.

TONLE & MEKONG DECKS

Category A & B

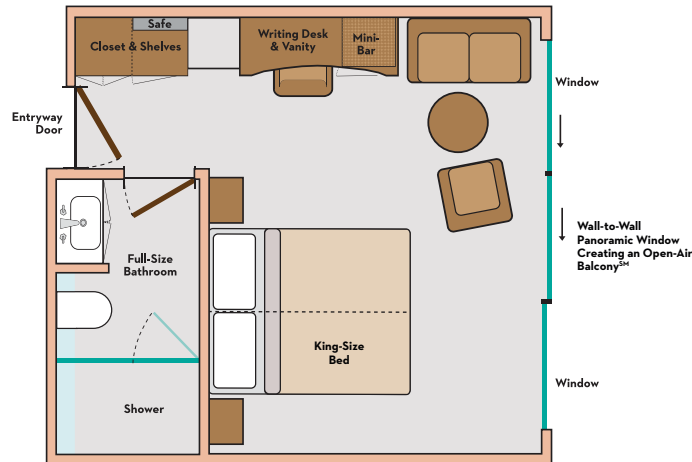

AMENITIES

- Comfort Collection BedsSM, featuring premium mattress covers
- Egyptian super-combed cotton linens, blankets & European-style duvets
- Soft & firm pillows
- Choice of bed configuration (two twins or one king)
- Nightly turn-down service
- Bedside tables with reading lamps
- 14' Wall-to-Wall Panoramic Window that opens to create a large Open-Air BalconySM
- Large private bathroom featuring full shower with glass door, hairdryer & premium bath products
- Spacious closets with shelves for ample storage
- Easy under-bed luggage storage
- Writing desk/vanity with mirror & comfortable chair
- In-house telephone
- Bathrobes & slippers
- Complimentary bottled water
- In-room safe
- Individual climate control



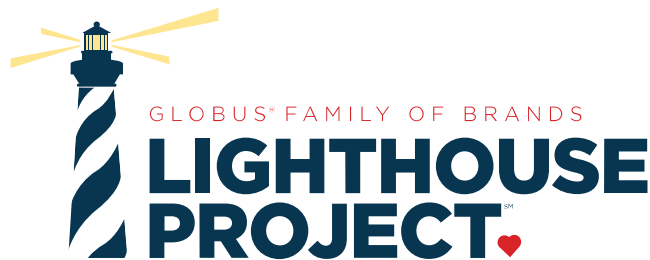

LIGHTING THE PATH TO A BETTER TOMORROW

From our inception, Avalon Waterways has cast a light on the world's most fascinating places and people – inviting wayfarers and wanderers like you to bask in their glory, intrigue and wonder. Along the way, we've helped travellers uncover ancient traditions while meeting the locals dedicated to preserving them; to meander historic hallways while giving back to the societies that safeguard them; and to put down the guidebooks and pick up a greater understanding of the world and its people.

Immersed in enlightening experiences, we naturally gain a deeper appreciation – one that leads to greater compassion, consideration and curiosity as we ask ourselves, what else can we do to protect our planet, preserve our sacred places and help humankind?

GLOBUS FAMILY OF BRANDS LIGHTHOUSE PROJECT

Enter the Avalon Waterways® Lighthouse Project – an illuminating initiative where we can all come together to tread lightly and give generously for the globe's greater good. Avalon, along with sister companies Globus and Cosmos, invite our travellers and partners to help us in supporting causes that provide for a more sustainable planet and a brighter tomorrow.

A CLEANER PLANET IS THE BEST REWARD

Avalon Waterways has been honored by Europe's Green Award—recognized for our Suite Ship® fleet's high safety and environmental standards. This prestigious award is given to river cruise ships based on the environmental impact of engines, fuel consumption, waste and maintenance, pollution prevention, and more.

NO ONE LOOKS OUT FOR **YOU LIKE FAMILY.**

MORE THAN 90 YEARS OF EXPERIENCE BACKED
BY THE GLOBUS FAMILY OF BRANDS.

When you charter with Avalon Waterways, the safety of our family — our travellers — is our top priority. Our entire team closely monitors situations at our destinations, and in the unlikely event of an incident, we implement ways to safely avoid trouble spots. As a global operator with over 50 offices worldwide offering global security and response teams ready to act both domestically and abroad, and the on-trip support of our expert Tour Directors, Cruise Directors and Local Hosts®, you can count on the Globus family of brands wherever you travel.

GLOBUS[®]
family of brands

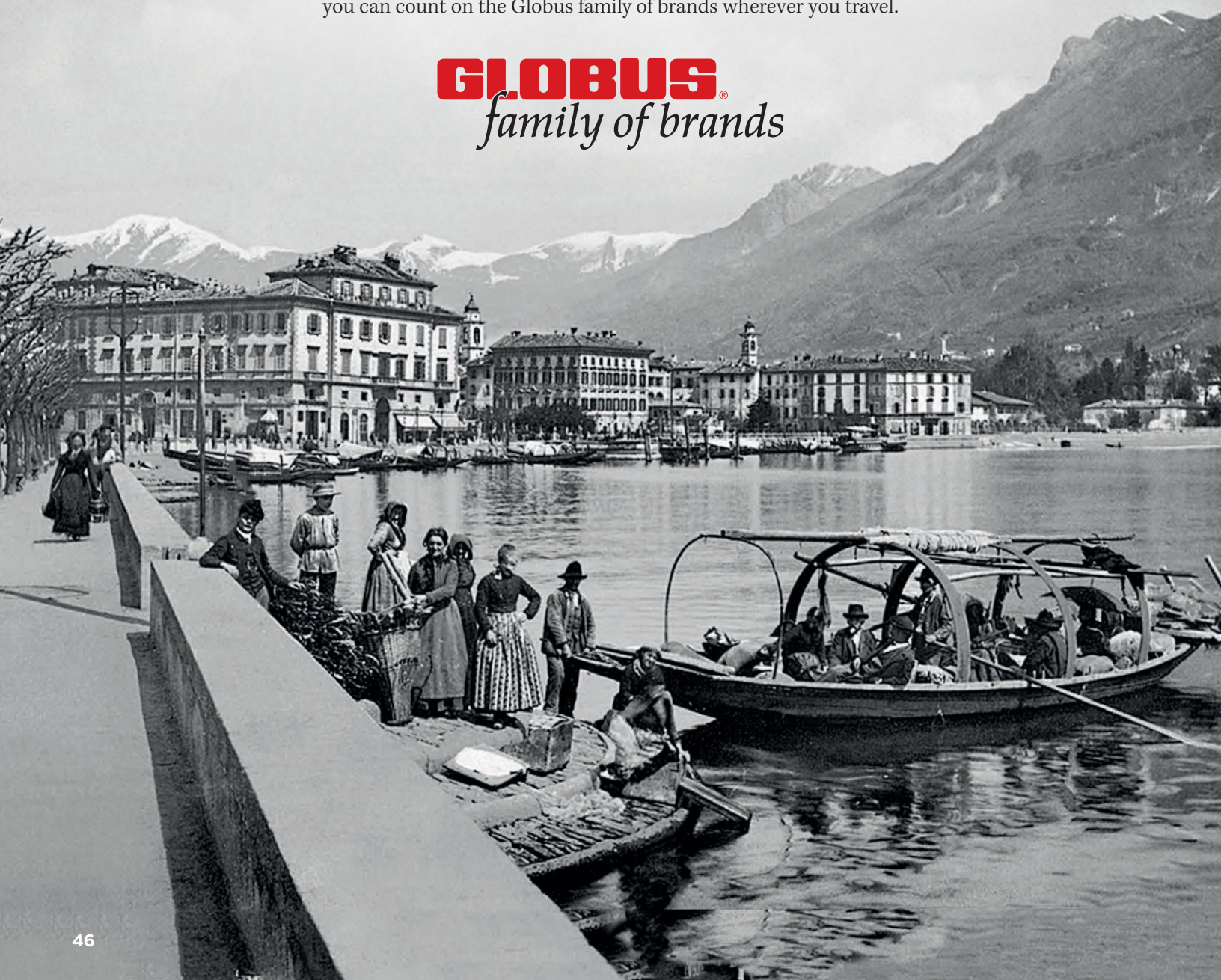

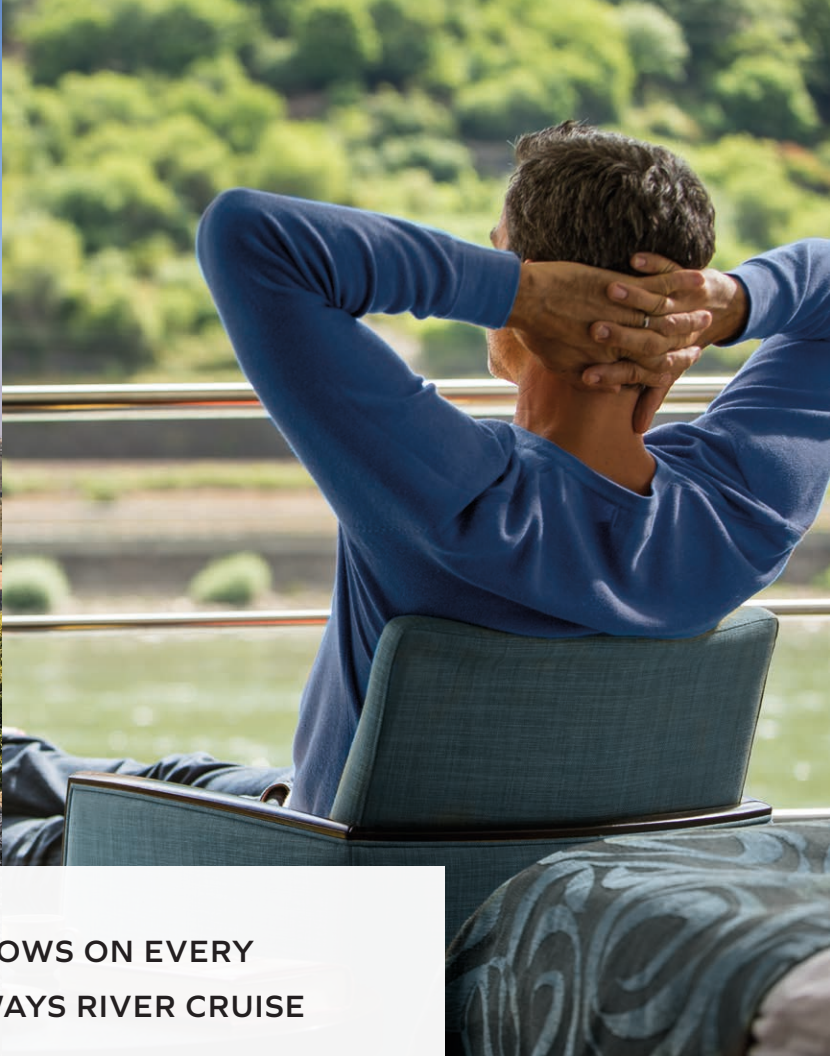

HAPPINESS FLOWS ON EVERY AVALON WATERWAYS RIVER CRUISE

Like the rivers we travel, Avalon Waterways is always moving forward and embracing the world ahead. From the relaxed luxury on board our Suite Ships® to the remarkable choices in how you cruise, we invite you to discover the difference for yourself aboard our award-winning river cruises in Europe, South America, Asia, Africa and other fascinating destinations!





THE POSSIBILITIES ARE AS **WIDE OPEN AS THE VIEW.**

If you're looking for a memorable way to unite a special group or reward top performers, you needn't look further than an Avalon Waterways charter. Along the legendary rivers of Europe and Southeast Asia, we offer a variety of enlightening itineraries, indulging travellers on board and off with the ideal combination of comfort, warmth, and luxury – all to reward yours with the perfect degree of relaxed indulgence.

CHARTERS – INCENTIVES – MEETINGS – EVENTS – SPECIAL INTEREST

AVALONWATERWAYS.CO.UK | 0330 808 4751
FOR ENQUIRIES CALL OR E-MAIL: GROUPS@AVALONCRUISES.CO.UK