



CRUISING ELEVATED



CHARTER & INCENTIVE RIVER CRUISES



AVALONWATERWAYS.COM.AU

CHOOSE A ONE-OF-A-KIND AVALON CRUISE AS YOUR NEXT VENUE.

It's hard to find a more immersive way to explore the world than on the great rivers that flow through the most iconic and inspirational destinations. And what better way to create inspiration and incentive for your special clients and guests than on an Avalon Charter cruise? Your exclusive and personalised charter cruise is designed as a reflection of you and your cruise companions with customised details in your signature style. Gather in thoughtfully appointed meeting spaces, complete with state-of-the-art equipment, including screens, projection, and microphones. And your guests never miss a beat with personalised content streaming on our in-room televisions. Your brand messaging and themes can also be presented via onboard amenities, from custom signage, keycards, and even cakes – just to name a few. Enjoy custom menu options and the choice of an all-inclusive drink package to entertain like a pro. Avalon can fully customise your charter itineraries to speak to your interests, with flexible sailing times and variable lengths of cruises to suit you perfectly.

TABLE OF CONTENTS

4	Charter & Incentive River Cruises	24	Avalon Suite Ships®
6	Panorama Suites SM	32	Where Avalon Sails
8	Open-Air Balcony SM	34	European Charter Itinerary Samples
10	Avalon Choice®	36	Avalon Mekong Itinerary
12	Active & Discovery Cruises SM	38	Special Interest River Cruises
14	Avalon Inclusions	40	Globus® Family Of Brands . Experience
16	Avalon Dining & Drinks	42	Globus® Family Of Brands Lighthouse Project
18	Avalon Fresh®		
20	On Board & On Shore Customisation		
22	Avalon Meeting Planning		







2024, 2023, 2022,
2020, and 2019
Readers Choice
Best Luxury River
Cruise Line



Best New Ship
Best Onboard
Dining
Best Suites



No. 1 Top-Rated
River Cruise Line
in Europe
Top 10 Best River
Cruise Ships



Best Cabins
in River Cruising
Best River Cruise
Line
Best Shore
Excursions



Top 10 River
Cruise Lines



Top 10 River
Cruise Line
Top River
Ships



Best River
Cruise Line



Best River
Cruise Accom-
modations



No. 1 Best River
Cruise Line
No. 1 Best River
Cruise Ship



Best River
Cruise Ship



AVALON WATERWAYS CHARTER & INCENTIVE RIVER CRUISES

Avalon Waterways has been showing groups the world since 2004. From large sales organisations, to franchise groups, to meetings, events and special interest groups, choose Avalon for the unmatched experience we deliver guests, and the intimate experience our ships deliver. A part of the Globus family of brands, a trusted travel provider for nearly 100 years, Avalon is the expert in designing river cruises and land programs for the MICE market across the world.

Our dedicated clients team provides unparalleled support and assistance throughout the entire process, from planning your cruise to ensuring the entire experience is a success beyond your expectations. You'll have an array of materials to promote to your clients to build excitement.

Our industry exclusive Suite ShipSM fleet provides your entire group the opportunity for the same large suite style cabin accommodations. All conference and incentive river cruise programs and onshore programs are fully customisable, so you can create the most unique and wow experiences for your clients.

Navigating elegance and ease, our crew delivers an exclusive and personalised experience. From the Captain and Cruise Director to your stateroom attendant and wait staff, Avalon provides warm and friendly service, mouthwatering cuisine, and unmatched experiences – to deliver the perfect degree of relaxed indulgence.

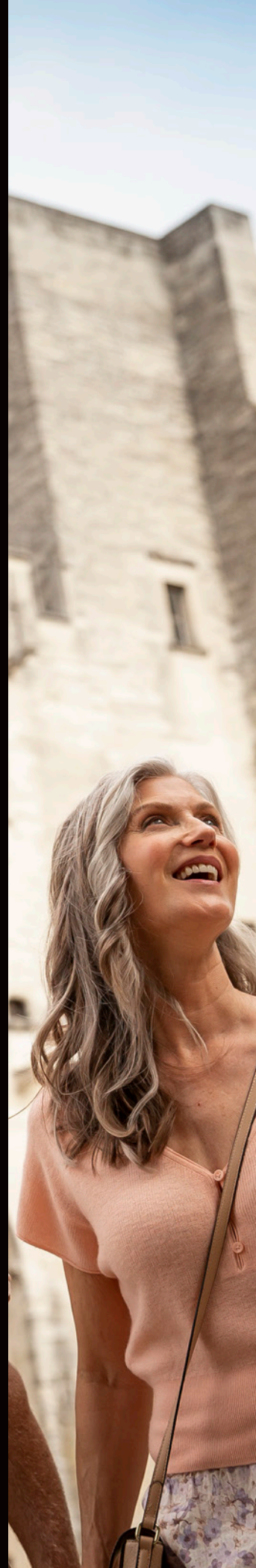

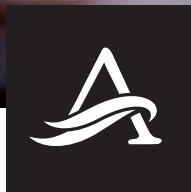

OH HOW SUITE IT IS

Everyone enjoys the same stateroom and the same amazing view.

There's only one point-of-view on an Avalon Waterways river cruise — the Suite view. You won't find the challenge of who to place in what cabin when choosing Avalon Waterways. Our unique Suite ShipsSM feature our signature Panorama SuitesSM with the widest opening windows in river cruising and beds facing the windows for your guests to enjoy what river cruising is all about — the ever changing views. On our Suite FleetSM in Europe, 80% of the staterooms are 18.6 square metres suites and in Southeast Asia, all rooms are Panorama Suites at a spacious 22.7 square meters.



At 18.6 square metres, the Panorama SuiteSM is more than 30% larger than the industry standard.



"Our stateroom was comfortable and attractive. People felt they had ample space and they loved the balcony windows. I was impressed with the strong water pressure in the shower and the L'Occitane toiletries smell wonderful..."



OPEN-AIR BALCONYSM

Wider openings for the wide-eyed.

Avalon Waterways Open-Air Balconies were designed with our guests' views in mind. The wall-to-wall, floor-to-ceiling windows open 11-feet wide in Europe and 14-feet wide in Southeast Asia... Wider than any other balconies in the industry.

Even better? Avalon's balconies do not sacrifice room space. In contrast, they invite our guests to enjoy 100% of their Panorama Suite, 100% of the time. And they're making a splash with Avalon's guests. In fact, according to a new survey of 652 past travellers, 95% would choose Avalon's Open-Air Balconies to traditional French balconies.

We're the only river cruise company that's figured out how to give our guests everything they want – more space, indoor/outdoor living, huge views for miles in the comfort and privacy of their rooms.



The largest standard windows in river cruising
with floor-to-ceiling, wall-to-wall views.

AVALON

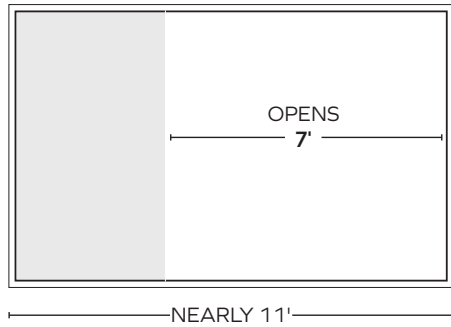

Our giant floor-to-ceiling window is nearly 11' wide.

THE COMPETITION

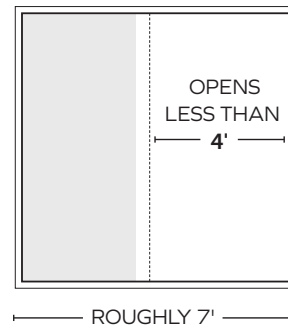

Standard window is roughly 7' wide, and opens less than 4'.





YOUR CRUISE. YOUR WAY.

EASY ON SHORE CUSTOMISATION WITH AVALON CHOICE

Our unique programs are not only fully customisable, they also include sightseeing with Certified Local Guides and ample free time for guests to explore on their own. Avalon Choice lets each individual on board personalise their day based on their interests and passions. We invite guests to select the activities and events that interest them the most so they can experience their cruise ...their way.

Explore **CLASSIC** sights, make a new **DISCOVERY** through hands-on cultural and artistic experiences shared by local residents and experts, or embark on **ACTIVE** excursions.



THE 3 TYPES OF AVALON CHOICE EXPERIENCES AVAILABLE ON EVERY CRUISE ARE:

CLASSIC

Our local expert is ready to guide your guests through the history and heritage of local destinations. Guests will marvel at the legends, lore, and spectacular architecture of iconic and historic sites.

DISCOVERY

We've found inspiring and interactive experiences to speak to guests' interests – from cooking classes, to painting workshops – guests can immerse themselves in each culture they explore.

ACTIVE

Embark on energetic experiences to keep you in motion and on the go – from a guided jogging tour to biking, paddling and hiking their way through scenic locales. These and so much more, are available for customisation for your guests. The possibilities are endless, and the experience of cruising with Avalon Waterways is sure to provide onshore delights and memories your guests will continue talking about long after they return home.

"The shore experiences were very good. The guides were very passionate about their cities, extremely knowledgeable, and very personable. There was a good mix of escorted & narrated experiences and free time. It was also wonderful when we could dock right in the centre of town."



ACTIVE & DISCOVERY CRUISES

AN IMMERSIVE CRUISE EXPERIENCE.

Why just see the famous sights of the world when you can participate in each destination's unique experiences? With Avalon's Active & Discovery cruises, you choose how to experience the world! Spark your inspiration with cultural discoveries or elevate your heart rate with active excursions that immerse you in the culture, cuisine, and captivating views! Pull up a chair to hear a Vienna waltz, roll up your sleeves to paint like Van Gogh, or grab an apron to whip up a local specialty. Discover the world's simple pleasures and grand artistry, from famous galleries to farmhouse kitchens. Greet the day with a bike ride, a hike to a hilltop castle, or a kayak excursion on Europe's extraordinary waterways. Go from observing to doing on an Avalon Active & Discovery cruise.

AFTER ALL, THE ADVENTURE IS UP TO YOU.



SCAN QR CODE TO
FIND OUT MORE ABOUT OUR
ACTIVE & DISCOVERY CRUISES



ACTIVE & DISCOVERYSM

EXPLORATION IN MOTION

For the traveler who thrives on motion and action, Avalon has created a broad menu of energetic excursions. You might find yourself on a hike tour in a French vineyard, on a biking tour around Vienna, or even on a canoe trip on the Danube. From a climbing trip up to a medieval castle to hiking in the forest, these included excursions pack real get-up-and-go for those who like to do the same.

ENGAGING EXPERIENCES

For those who believe that life is about trying new things, Avalon presents an inspiring selection of interactive excursions created for the different kind of “doer.” These hands-on experiences include a painting class in Amsterdam, tasting locally produced cheese and beer at an ancient abbey, or saying “good morning” to Vienna on an early-riser walk to a quaint café for breakfast like a local. Traditions come to life as you shift from observer to participant in a variety of creative and engaging endeavours.





EXCLUSIVE MEETS INCLUSIVE

What's included beyond a flawlessly
planned program for your guests — everything

In our quest to make every guest feel perfectly at home, we include the features — both big and small — that make your cruise with us as rich as possible. An exclusive experience features all the right inclusions, yet still leaves room for personalisation. In addition to little luxuries like complimentary Wi-Fi and around-the-clock cappuccinos, Avalon gives you the greatest luxury of all — the freedom to customise your conference or incentive cruise with endless options.



Always included on Avalon Waterways charter & incentive cruises:

- AVALON CHOICE® included experiences with Certified Local Guides, and ample free time for guests to explore on their own. Explore CLASSIC sights, embark on ACTIVE excursions, and make a new DISCOVERY through hands-on cultural and artistic experiences shared by local residents and experts.
- Onboard breakfast, lunch & dinner, including daily four-course à la carte dinners with choice of appetisers, soups, salads, entrees, desserts, and Avalon Fresh® healthy cuisine options.
- Complimentary regional wine, beer, and soft drinks at lunch and dinner on board, sparkling wine with breakfast.
- Complimentary house beer, wine and spirits as well as a featured cocktail of the day during Happy Hour each day.
- Club Lounge with 24-hour beverage station with complimentary cappuccinos, lattes, tea, hot chocolate and premium coffees, as well as treats throughout the day.
- Complimentary AV Equipment.
- A professional Cruise Director who delivers educational commentary while travelling through interesting landscapes, and who assists with requests and additional unique experiences. The Cruise Director is there to make sure our guest experiences exceeds their expectations.
- Onboard local entertainment
- Complimentary Wi-Fi throughout the ship
- Fitness Center
- Avalon Adventure Center and Adventure Host, available for your guests for fitness activities and active experiences.

A photograph of a man and a woman sitting at a table in a restaurant, smiling and looking at each other. The table is set with plates of food, glasses of water, and wine. In the background, other diners are visible but out of focus. A dark rectangular box with white text is overlaid on the center of the image.

"The meals were absolutely delicious. Seriously good...The daily variety and quality of all the food was excellent and thoroughly appreciated. And it was so nice to be able to have a Caesar salad or steak & potato on the day when comfort food was desired. Hats off to the entire kitchen staff."



EVERY MEAL IS PART OF THE JOURNEY.

OUR DINING EXPERIENCE

From morning breakfast to elegant dinners, Avalon frees your taste buds from the ordinary. Choose the onboard dining venue that suits your mood — from a breezy al fresco lunch at the Sky Grill to an elegant four-course dinner in the glass-walled dining room. For a less formal “sitdown” atmosphere, guests can take a more casual approach to fine dining while mingling over satisfying selections in our Panorama Bistro. Whichever venue your guests choose, they’ll savour local flavours and the familiar favourites you may crave — as well as our Avalon Fresh® menu options — throughout your cruise.

ONBOARD DINING OFFERINGS & CHOICES:

- Captain’s welcome & farewell receptions with sparkling wine & canapés
- Daily choices of regional recipes, familiar favourites, and Avalon Fresh® vegetarian and healthy cuisine including fresh, local ingredients at every meal
- Daily full breakfast à la carte with made-to-order egg station, hot and cold menu items, and complimentary sparkling wine & juices
- Daily lunch buffet with rotating chef’s features including carving & pasta stations, and complimentary beer, wine, and soft drinks
- Choice of alternative fare at the Sky Grill on the Sky Deck (weather permitting) or light lunch in the Panorama Lounge
- Enjoy our Panorama Bistro for a casual dinner option with a petite plate à la carte of select dishes and beverages
- Daily Afternoon Tea featuring tea, coffee, sweet treats & sandwiches
- Daily four-course à la carte dinners in the main dining room with choice of appetisers, soups, salads, entrées, desserts or cheese, after-dinner premium coffees or tea, and complimentary wine (including from the region), beer, and soft drinks
- Complimentary room service available for Continental breakfast & beverages
- FlexDiningSM with flexible seating-times at dinner to better accommodate your schedule
- Made-to-order picnic lunch boxes for independent onshore experiences
- Special Dietary options upon request

DRINK PACKAGES:

Whether you want your guests to have all cocktails included each day or select a package of drink selections for your cruise outside of meal times, we can help you design the best offering for your budget and your group.

LOCAL. HEALTHY. **AVALON FRESH**®

Who says healthy cuisine can't be inspiring? On an Avalon Waterways river cruise, you can take an indulgent holiday without drifting from your healthy habits. Our Avalon Fresh selections are exclusively created in collaboration with Austrian brothers Leo and Karl Wrenkh, leading chefs in the healthy-dining movement. Using the freshest ingredients from local farms and suppliers, our chefs create flavorful dishes with a dash of innovation. These creative yet wholesome options are available at every meal we serve on board. Whether you're looking for an energising juice at breakfast, an artfully crafted salad at lunch, or a satisfying plate at dinner, Avalon Fresh steps up to the plate with the perfect ingredients to fuel your day.





THE PERFECT PAIRING

Brothers Karl and Leo Wrenkh—two of Europe’s rising culinary stars—have partnered with Avalon to present the latest concept in “haute cuisine.” With the addition of Avalon Fresh®, travellers can guiltlessly indulge in a mouthwatering menu that combines the freshest ingredients with surprising flavours and a dash of innovation. With the philosophy of procuring ingredients from small farms and local producers, the Wrenkh brothers bring the passing landscape to the plate for an inspiring, fulfilling, and healthful dining experience.

THE LIBATIONS YOU’LL LOVE

Linger over signature cocktails and standard concoctions with a twist. Toast your adventures with the original Espresso Martini or Easy Stinger — just two of our craft cocktails designed by Avalon’s award-winning mixologist, Martin Hudák. Raise your glass and lift your spirits with your choice of remarkable refreshments in our Panorama Lounge.

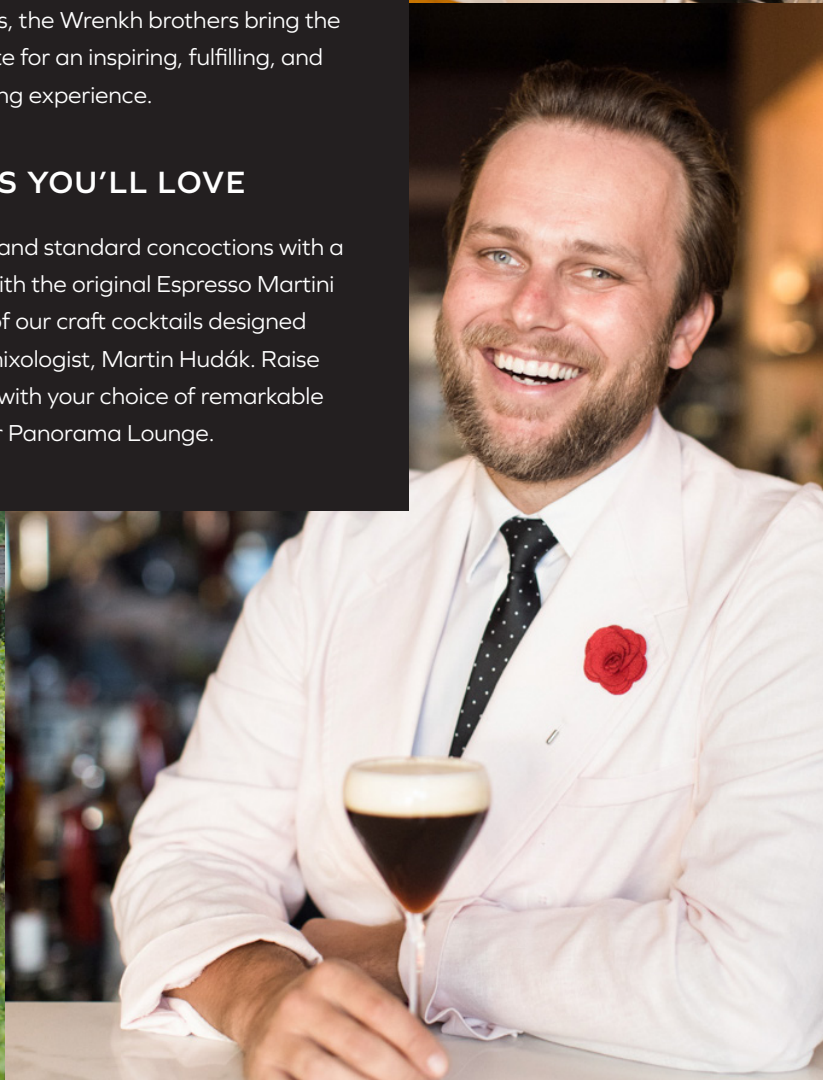

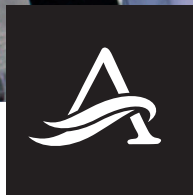

CUSTOMISATION IS WELCOME HERE, ON BOARD & ON SHORE.

You dream it. We'll deliver it.

Looking for something unexpected and unique? Our passion is ensuring you and your guests are delighted through the planning process to cruise end. We can fully customise your program, and offer the opportunity for exclusive excursions and onboard events personalised for your group.

With Avalon Waterways, you have choices. From where to sail, how long to sail, where to port, to the number of activities and onshore events, we make the cruise personalised for you. Not sure what is best? We'll help make the process seamless, building a program that makes it easy for you to pick and choose what activities and destinations will leave your guests enchanted.

Have a dream in mind? Let us help make it a reality. Not sure what to even dream? We're here to help with that too.

OPTIONS TO CREATE THE PERFECT CRUISE PROGRAM FOR YOUR GUESTS.

- Customisable Ports
- Flexible Sailing Times
- Variable Length of Cruise
- Onshore Activities
- Exclusive Galas & Events
- Pre and post cruise land stays
- Tandem and multi-ship charter programs available for larger groups
- Flexible meeting space with audio/visual
- Customised menu options
- Customisable signage, key cards, banners, flags, etc.

"I have had the pleasure of working with Avalon Waterways for many years on incentive group voyages... Avalon is consistently exceptional. One of the primary reasons for success is the willingness to adapt, create, and deliver out of the box ideas to make river cruising a unique and customised experience."





WORK TO PLAY. DAY TO NIGHT. ALL YOUR WAY.

Avalon Waterways has you covered handling all the details
in perfectly executing successful events day and night,
from meeting planning to evening entertainment for your guests.



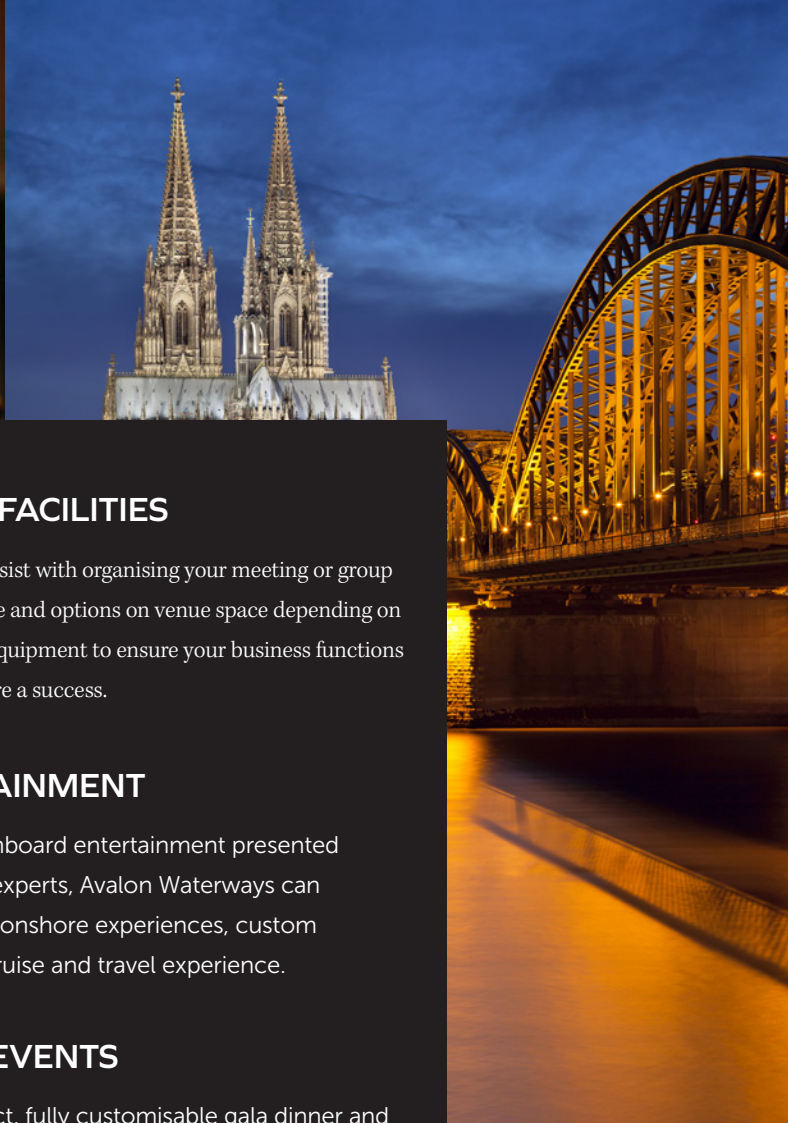
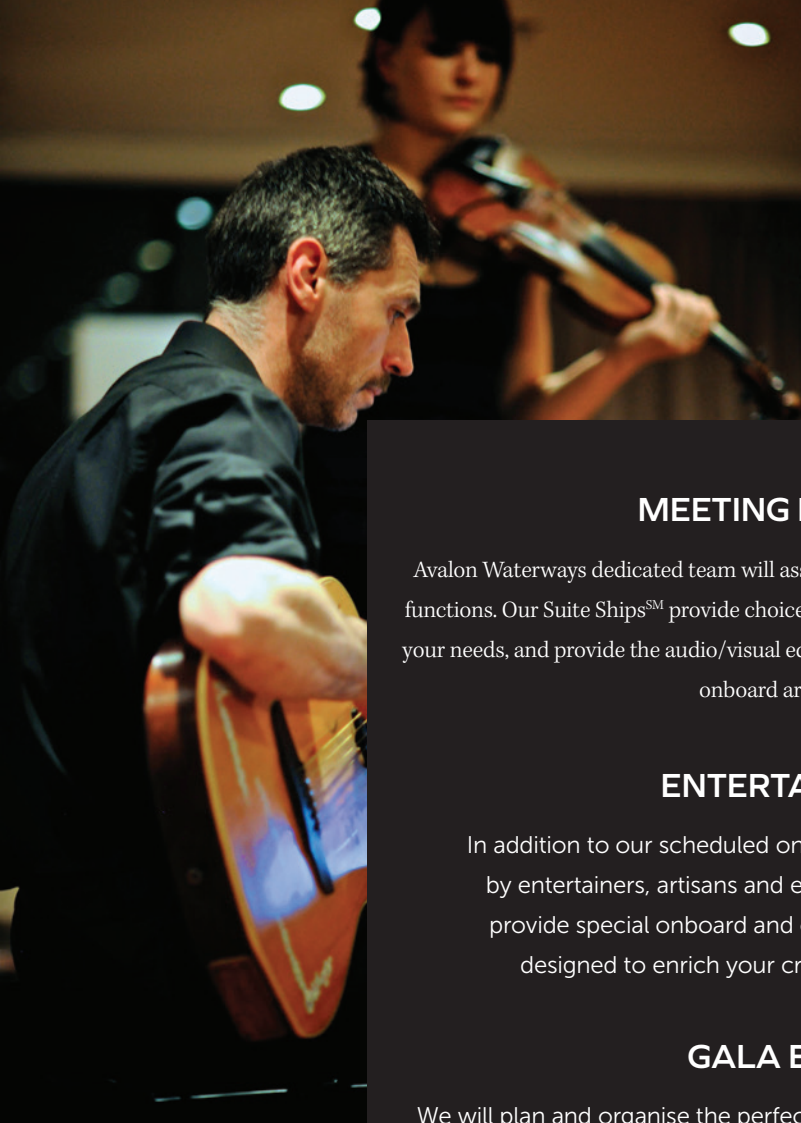

MEETING FACILITIES

Avalon Waterways dedicated team will assist with organising your meeting or group functions. Our Suite ShipsSM provide choice and options on venue space depending on your needs, and provide the audio/visual equipment to ensure your business functions onboard are a success.

ENTERTAINMENT

In addition to our scheduled onboard entertainment presented by entertainers, artisans and experts, Avalon Waterways can provide special onboard and onshore experiences, custom designed to enrich your cruise and travel experience.

GALA EVENTS

We will plan and organise the perfect, fully customisable gala dinner and event for your group. Step off the ship and enjoy the culture of one of the port towns in an unexpected and memorable way. From dining in castles and museums, to a party in Paris under the lights of the Eiffel Tower, we will assist in making your event a remarkable experience for your guests.

“My experience with Avalon from the initial booking process to the planning and operation was virtually flawless. The onboard accommodations, food and beverage and unique experiences exceeded client expectations, but the professional and friendly staff really made the difference.”



OTHER AMENITIES:

- Elevator in Europe
- Complimentary room service available for Continental breakfast and beverages
- English-speaking TV channels with over 50 free movie options
- Complimentary water dispensers throughout the ship. Fill your reusable bottle with a variety of beWell™ Essences flavours or with clear or sparkling water.

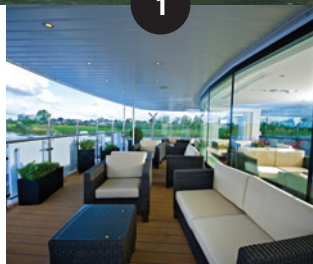

Observation Lounge

Breathe in the peaceful space and perfect vantage point on the river while relaxing in our Observation Lounge. Stretch out with coffee, wine, or whatever you please to watch the scenic shorelines, hills, and valleys.



Panorama Bistro

The ideal spot for a casual dinner in a social setting to mingle with your travelling companions and fellow Avalon guests. Enjoy petite plates of delicious dishes and beverages.



Panorama Lounge & Bar

Enjoy cosy seating, panoramic windows, and a dance floor to enjoy the evening's entertainment or unique artisan demonstrations. Visit the Panorama Bar for your favourite libation—or to try something new by our creative mixologists.



Sky Deck

The perfect place to take in the sights of the passing landscape or mingle with fellow travellers. Features a whirlpool and seating galore to soak up the sun or drink in the moonlight. Bring your appetite to the Sky Grill for made-to-order lunch dishes to enjoy as you watch the world go by.



SMALL DETAILS. BIG DIFFERENCE.

Avalon Waterways provides the perfect setting for any successful event. Our European Suite ShipsSM atmosphere seamlessly blends relaxation and casual luxury into what guests' experience on board. Your group deserves the best of everything.



Dining Room

From morning breakfast to elegant dinners, Avalon frees your taste buds from the ordinary. In this glass-walled dining room, you'll savour local flavours (and familiar favourites, should you crave them) as well as our Avalon Fresh[®] menu offerings. Every meal is a part of the journey.



Adventure Center

Find the gear, maps, and more for active pursuits on ship and off. Check out a bike, grab a Nordic walking stick and head up to a fortress on a hill, or join a guided jog. Whether you're looking for a yoga class on deck or an optional canoe excursion, your Avalon Adventure HostSM can make it happen.

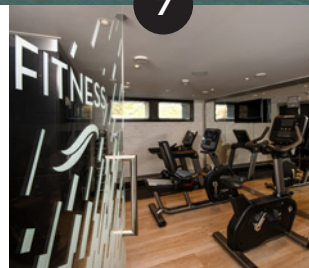

Fitness Center

Just because you've gone on holiday, doesn't mean your fitness regimen has to. Visit our fully equipped Fitness Center for a great workout on your schedule. Get your crosstraining in with a bike, treadmill, and weights.



Club Lounge

Our beautiful airy and open lounge features a 24-hour beverage station offering complimentary Lavazza coffee, decaffeinated coffee specialties, cappuccinos, lattes, hot chocolate, and a selection of teas. Cookies are available throughout the day.



YOUR SHIP HAS COME IN. AVALON EUROPE SUITE SHIPSM:

64 Cabin ships – 128 guests | 83 Cabin ships – 166 guests

SKY DECK

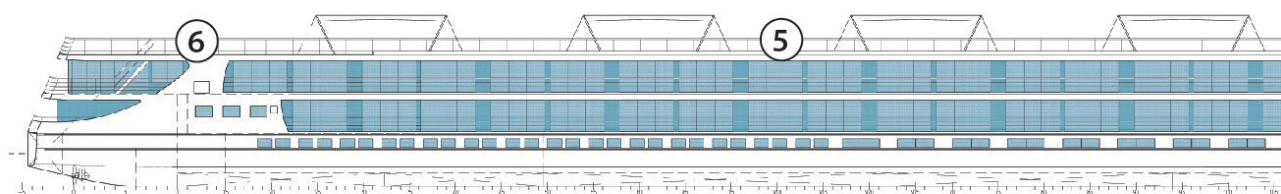

ROYAL DECK



SAPPHIRE DECK

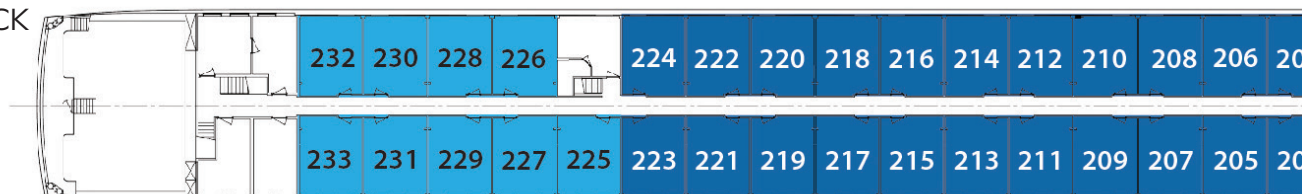

INDIGO DECK

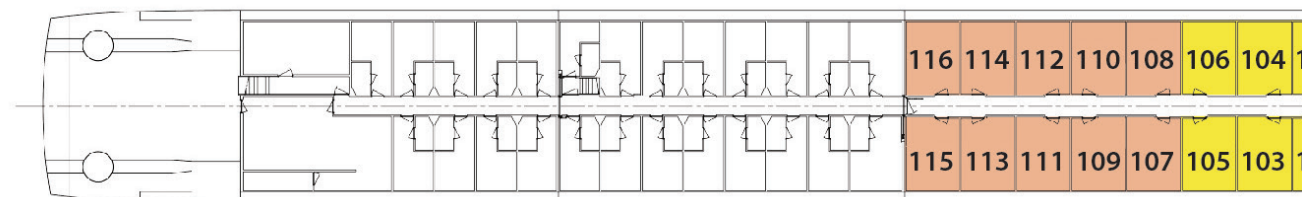

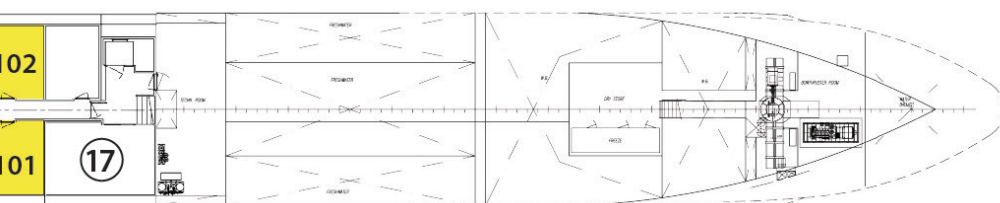
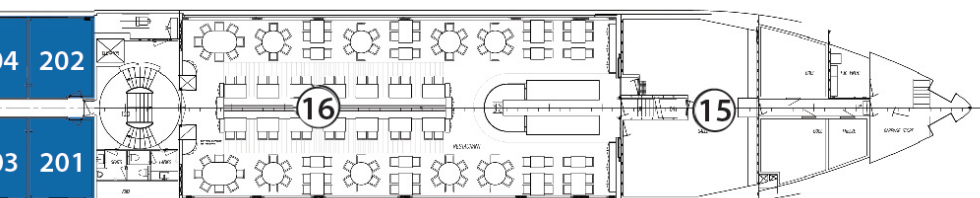
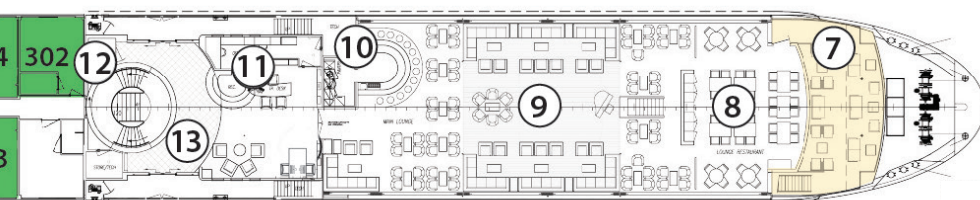
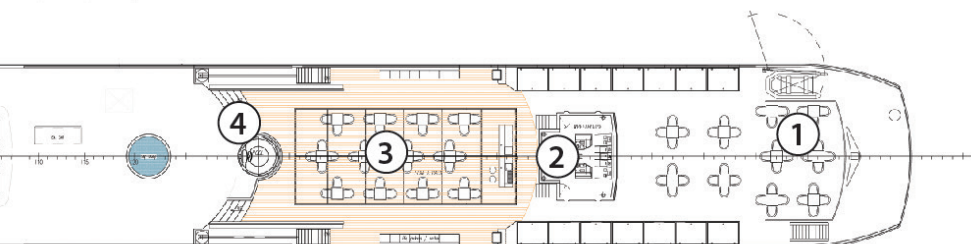
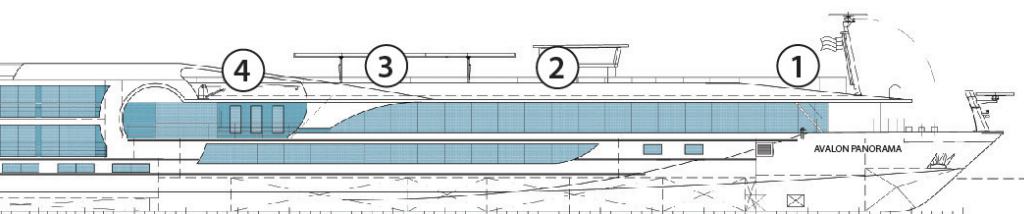
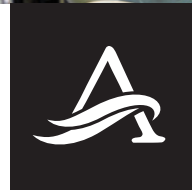

- 1 Sky Lounge
- 2 Navigation Bridge
- 3 Sky Grill
- 4 Whirlpool
- 5 Premium Lounge Chairs and Shade Awnings
- 6 Deck Game Area
- 7 Observation Lounge
- 8 Panorama Bistro
- 9 Panorama Lounge
- 10 Bar
- 11 Reception
- 12 Elevator
- 13 Lobby
- 14 Club Lounge
- 15 Galley
- 16 Dining Room
- 17 Fitness Center

ROOM CATEGORY LEGEND

Royal Suite	Royal Deck Royal Suites
Cat. P	Royal Deck Panorama Suites
Cat. A	Sapphire Deck Forward Panorama Suites
Cat. B	Sapphire Deck Aft Panorama Suites
Cat. D	Indigo Deck Aft Deluxe Staterooms
Cat. E	Indigo Deck Forward Deluxe Staterooms



THE ART OF MAKING YOU FEEL AT HOME.

ROYAL SUITES

27.8 SQM
ROYAL DECK

- Comfort Collection BedsSM, featuring premium memory foam mattress toppers with special construction for increased airflow and ventilation and a choice of four firmness selections – from extra firm to pillow-top soft
- Egyptian super-combed cotton linens, blankets and European-style duvets
- Soft and firm pillows
- Choice of bed configuration – two twins or one queen or (Royal Suite only) one king
- Nightly turn-down service
- Bathrobes and slippers
- Bedside tables with reading lamps
- Large private bathroom featuring full shower with glass door, hairdryer, premium L'Occitane[®] amenities and plenty of storage
- Spacious 3-door closets with shelves for ample storage
- Easy under-bed luggage storage
- Flatscreen satellite TV with movie channels
- Writing desk/vanity with mirror and comfortable chair
- Complimentary Wi-Fi access
- Direct-dial telephone
- Well-stocked minibar
- USB Ports
- In-room safe
- Individual climate control

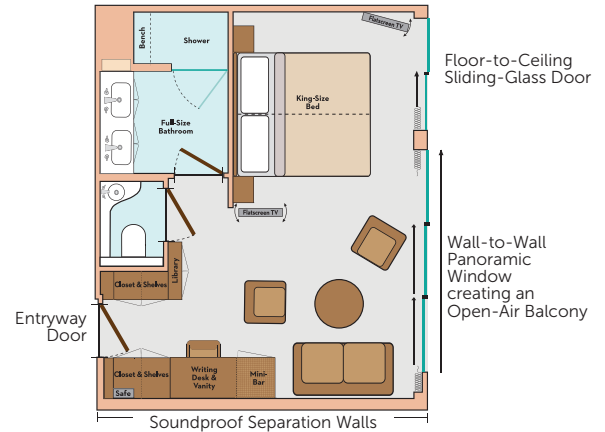

PANORAMA SUITESSM

18.6 SQM
ROYAL & SAPPHIRE DECKS
Category B, A, P

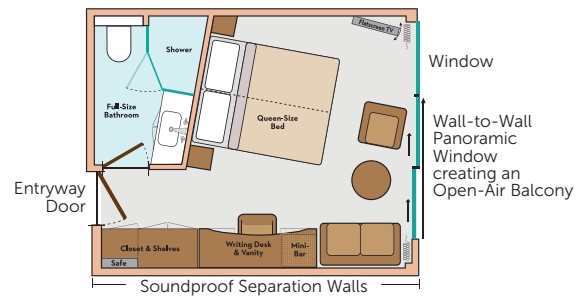

DELUXE STATEROOMS

15.97 SQM
INDIGO DECK
Category D & E

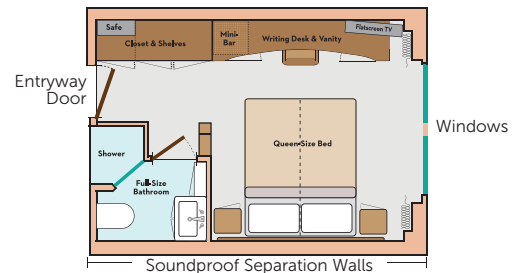



CRUISING ON THE DOURO RIVER

AVALON ALEGRIASM (2024)

Passengers: 102 | Crew Members: 33 | Length: 80m | Decks: 4. | Deluxe Staterooms: 14 (15.97 sqm & 16.72 sqm) | Panorama Suites: 37 (18.6 sqm)

SIDE VIEW & SKY DECK

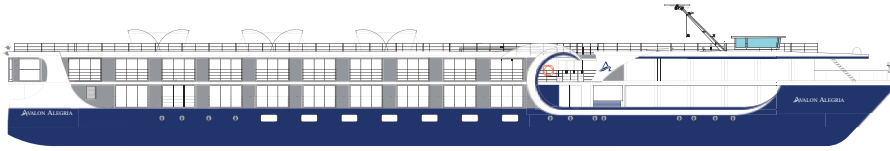

ROYAL DECK



SAPPHIRE DECK



INDIGO DECK

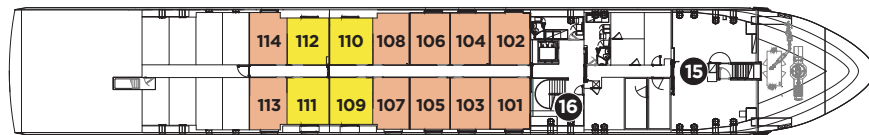

DECK PLAN

- 1 Sky Lounge
- 2 Premium Lounge Chairs and Shade Awnings
- 3 Sky Grill
- 4 Pool
- 5 Navigation Bridge
- 6 Club Lounge
- 7 Elevator
- 8 Adventure Center
- 9 Reception
- 10 Bar
- 11 Panorama Lounge
- 12 Panorama Bistro
- 13 Observation Lounge
- 14 Dining Room
- 15 Galley
- 16 Fitness Center

CATEGORIES

CAT. P	Royal Deck Panorama Suites
CAT. A	Sapphire Deck Forward Panorama Suites
CAT. B	Sapphire Deck Aft Panorama Suites
CAT. D	Indigo Deck Deluxe Staterooms
CAT. E	Indigo Deck Deluxe Staterooms



CATEGORY E DELUXE STATEROOM

15.97 SQM

INDIGO DECK

*Room configuration may vary slightly

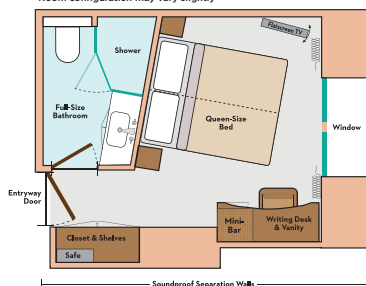

CATEGORY D DELUXE STATEROOM

16.72 SQM

INDIGO DECK

*Room configuration may vary slightly

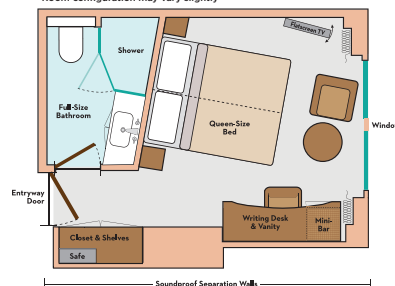

PANORAMA SUITE

18.6 SQM

ROYAL & SAPPHIRE DECK

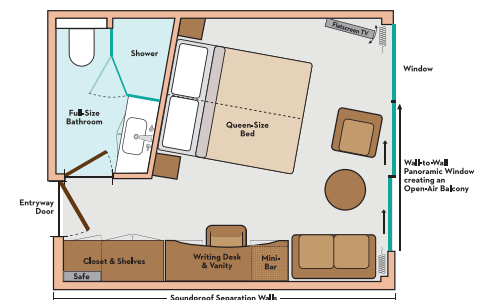

AMENITIES

- Complimentary Wi-Fi throughout the ship
- Panoramic windows throughout the ship
- Elegant, contemporary design & decor
- Friendly, English-speaking crew & Cruise Director
- Covered Observation Lounge

- Sky Deck features swimming pool, shade awnings, and premium lounges)
- Club Lounge with 24-hour self-serve beverage station with complimentary cappuccinos, lattes, tea, hot chocolate & premium coffees, as well as treats throughout the day

- Elevator
- Non-smoking interior and staterooms
- Active shore excursions, both included and optional
- Fitness Center
- Avalon Adventure Center

CRUISING ON **THE MEKONG RIVER**

AVALON SAIGONSM (2018)

Passengers: 36 | Crew Members: 24 | Length: 59.4m | Decks: 2 | Suites: 18 (22.7 sqm.)

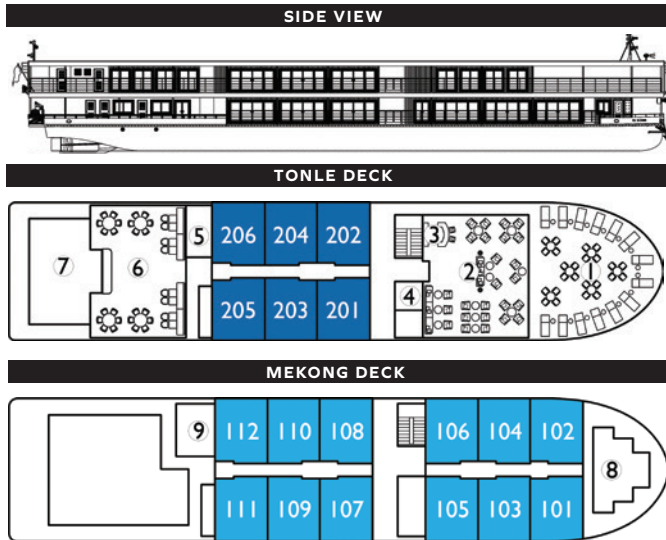

- | | | |
|--|----------------------|---------------------|
| 1 Open-air observation lounge with premium lounge chairs | 2 Panorama Lounge | 6 Dining Room |
| | 3 Bar | 7 Galley |
| | 4 Reception | 8 Navigation Bridge |
| | 5 Spa treatment room | 9 Fitness Center |

CAT. A Tonle Deck | Panorama Suites
CAT. B Mekong Deck | Panorama Suites

SHIP AMENITIES

- Air-conditioned Panorama Lounge
- Open-air observation lounge with shade system & premium lounge chairs
- Spacious, open-seating Panorama Dining Room
- Bar serving premium spirits, wine & complimentary coffee, tea, soft drinks, and local beer/spirits throughout the day
- Complimentary Wi-Fi access in the lounges (where signal is available)
- Spa treatment room
- Fitness Room
- Library and games
- Non-smoking staterooms & ship interior



PANORAMA SUITESSM

22.7 SQM

TONLE & MEKONG DECKS
 CATEGORY A & B

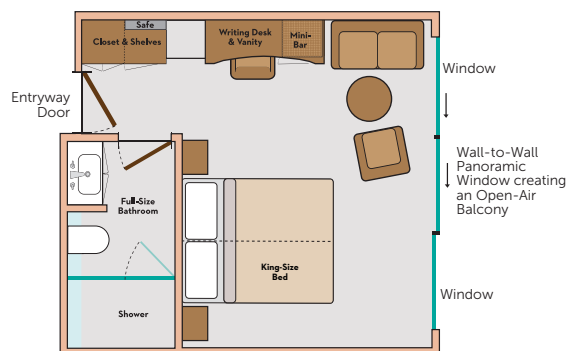

AMENITIES

- Comfort Collection BedsSM, featuring premium mattress covers
- Egyptian super-combed cotton linens, blankets & European-style duvets
- Soft & firm pillows
- Choice of bed configuration (two twins or one king)
- Nightly turn-down service
- Bedside tables with reading lamps
- 14' Wall-to-Wall Panoramic Window that opens to create a large Open-Air BalconySM
- Large private bathroom featuring full shower with glass door, hairdryer, and premium bath products
- Spacious closets with shelves for ample storage
- Easy under-bed luggage storage
- Writing desk/vanity with mirror & comfortable chair
- In-house telephone
- Bathrobes & slippers
- Complimentary water
- In-room safe
- Individual climate control



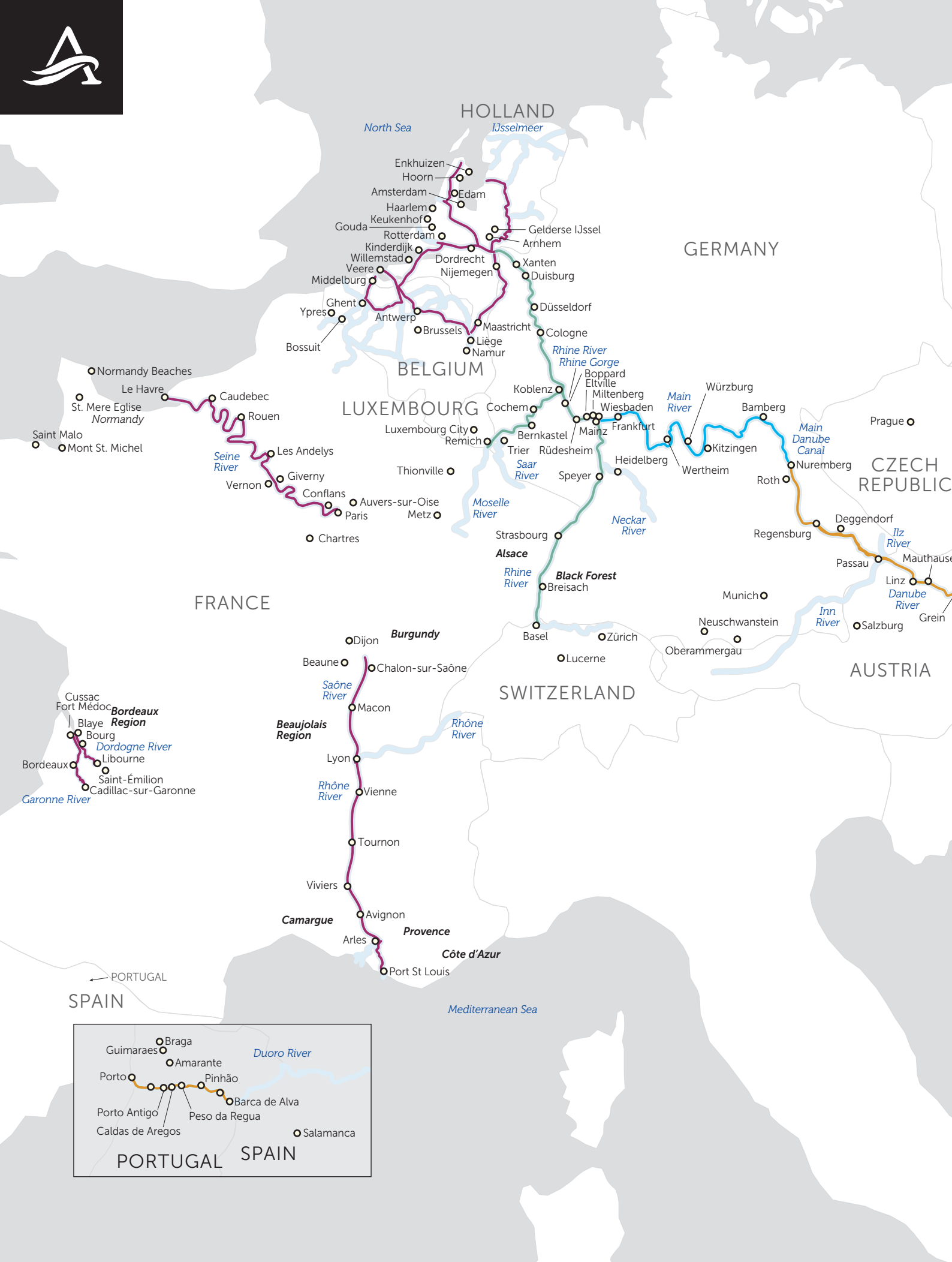

GREAT RIVERS TO ROAM.

Gently rambling, eagerly flowing, wildly rushing... each of Europe's legendary waterways have a distinct personality and a long, fascinating history. Whether you choose the blue Danube, the romantic Rhine, or one of the many other rivers, your perspective on this magnificent continent will be forever changed.





A SAMPLING OF OUR MOST POPULAR EUROPEAN PROGRAMS:

A TASTE OF THE DANUBE

4 days | Budapest to Vienna (and reverse)

Budapest – Bratislava – Melk – Dürnstien – Vienna



SCAN QR CODE TO
FIND OUT MORE ABOUT
A TASTE OF THE DANUBE
CRUISES

DANUBE SYMPHONY

6 days | Vilshofen to Budapest (and reverse)

Vilshofen – Linz – Mauthausen – Ybbs –
Krems – Vienna – Bratislava – Budapest



SCAN QR CODE TO
FIND OUT MORE ABOUT
DANUBE SYMPHONY



ROMANTIC RHINE



BUDAPEST



DÜRNSTEIN

THE LEGENDARY DANUBE

8 days | Nuremberg to Budapest (and reverse)

Nuremberg – Roth – Regensburg – Passau –
Linz – Melk – Vienna – Budapest



SCAN QR CODE TO
FIND OUT MORE ABOUT
THE LEGENDARY DANUBE

PARIS TO NORMANDY

8 days | Paris to Paris

Paris – Vernon – Les Andelys – Caudebec – Normandy
Rouen – Conflans – Paris



SCAN QR CODE TO
FIND OUT MORE ABOUT
PARIS TO NORMANDY

ROMANTIC RHINE

8 days | Amsterdam to Basel (and reverse)

Amsterdam – Cologne – Rüdesheim – Mainz –
Heidelberg – Strasbourg – Breisach – Basel



SCAN QR CODE TO
FIND OUT MORE ABOUT
ROMANTIC RHINE

BURGUNDY & PROVENCE

8 days | Chalon-sur-Saône to Arles (and reverse)

Chalon-sur-Saône – Mâcon – Lyon – Tournon –
Viviers Avignon – Arles



SCAN QR CODE TO
FIND OUT MORE ABOUT
BURGUNDY & PROVENCE



SOUTHEAST ASIA: INTIMATE CRUISING AT ITS BEST

Avalon Saigon – Mekong River – 18 Cabins
– 36 guests

Avalon river cruises go beyond expectation. They go beyond the grand waterways of Europe, too, winding down the intriguing waters of the Mekong in Southeast Asia. Our incredible Suite ShipSM along the Mekong River carries just 36 guests for a more exclusive experience. Gliding through narrow passageways, the smaller vessel gets travellers up close to the exotic sights, cultures, and traditions, leading to areas virtually untouched by tourists. Personalised touches abound throughout this cruise.

THE MEKONG RIVER

Pulsing through the heart of Vietnam and Cambodia, the Mekong River provides a lifeline for millions of people. Along this vibrant “Mother of Water,” scenes of everyday life will mesmerise your guests — from fishermen hauling in their daily catch to chanting monks to boats crisscrossing the river. Cruise the massive Mekong Delta, meet with smiling schoolchildren, see skilled silversmiths at work, and partake in a traditional water blessing ceremony with area monks. Explore French-influenced Phnom Penh, take a walking tour of Ho Chi Minh City, marvel at spectacular Angkor Wat in Siem Reap, and relish other fascinating activities.



SCAN QR CODE TO
FIND OUT MORE ABOUT OUR
MEKONG CRUISES





POPULAR SOUTHEAST ASIA PROGRAM:

FASCINATING VIETNAM, CAMBODIA AND THE MEKONG RIVER

13 days | from Siem Reap to Ho Chi Minh City (and reverse)
Siem Reap – Phnom Penh – Wat Hanchey – Angkor Ban –
Kampong Tralach – Konpong Louang – Chau Doc –
Long Khanh A – Cu Lao Gieng – Vinh Long – Ho Chi Minh City

7-night cruise-only programs available
on Southeast Asia Mekong cruises

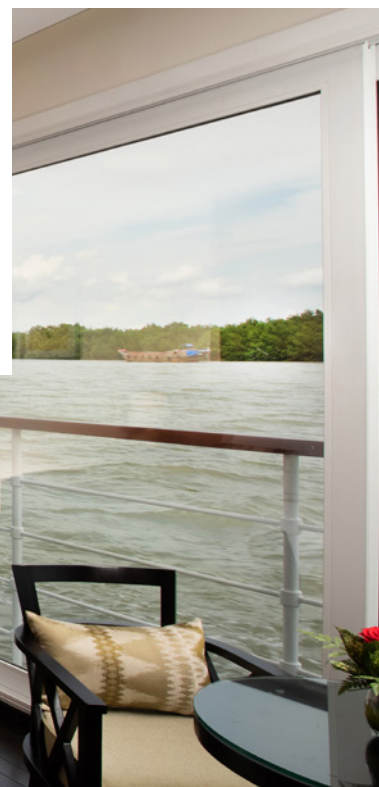



PACK YOUR PASSIONS.

AVALON HAS OPTIONS CATERING TO THE UNIQUE
INTERESTS OF YOUR GROUP.

Whether you want to incorporate your guests' passion for wine or photography, we have your groups' special interests in mind. Our Special Interest Cruises unite your guests with their pastimes — and other like-minded enthusiasts — both on the ship and off.

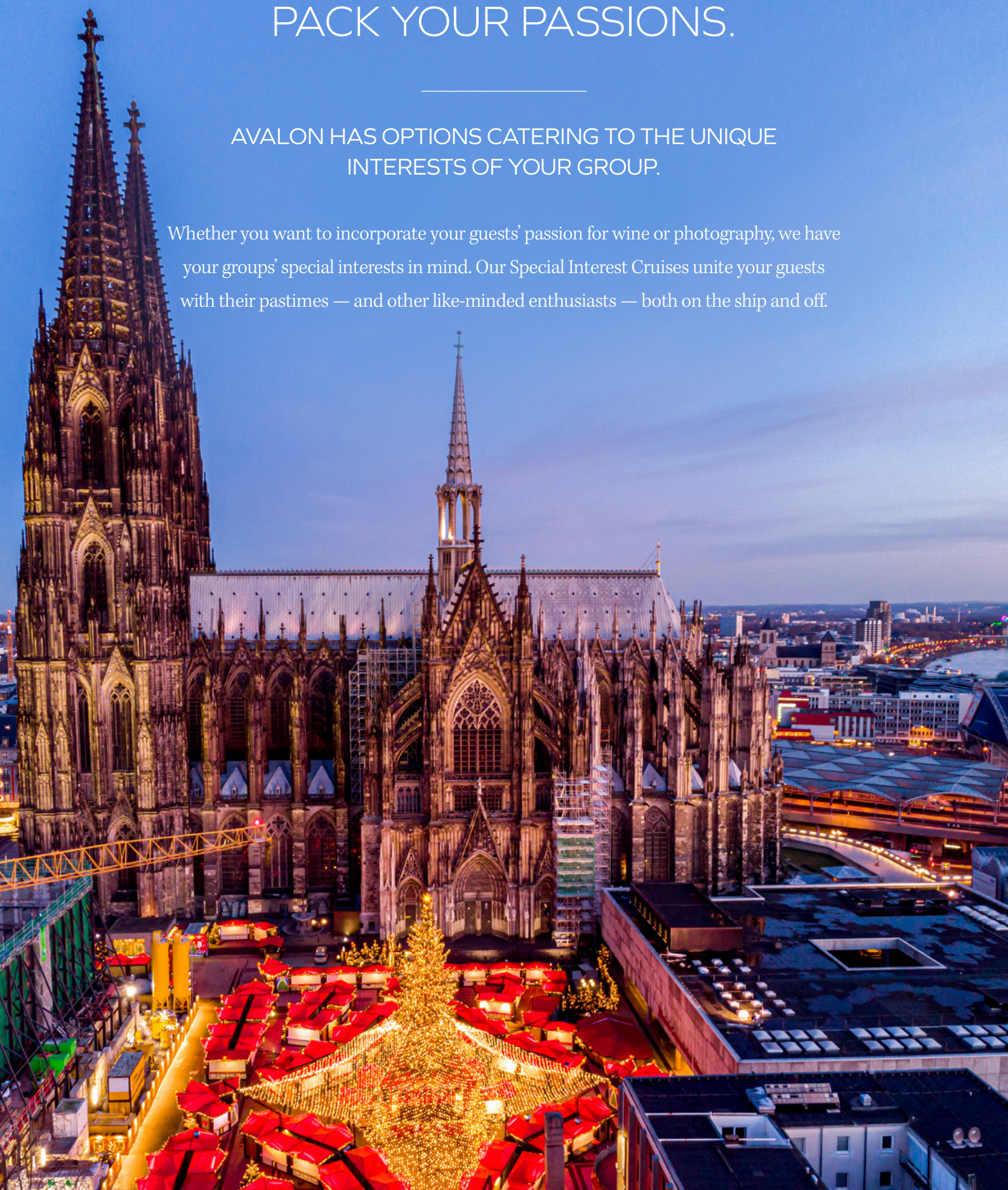



SPECIAL INTEREST RIVER CRUISE SELECTIONS:

BEER-TASTING

CULINARY

FESTIVE TIME

GARDEN & NATURE-LOVER

HISTORY

JEWISH HERITAGE

PHOTOGRAPHY

WINE APPRECIATION

All of our Special Interest programs are fully
customisable for conference and incentive cruises.
Visit www.avalonwaterways.com.au/experiences
for a complete list of themed cruises.



SCAN QR CODE TO
FIND OUT MORE ABOUT OUR
SPECIAL INTEREST CRUISES

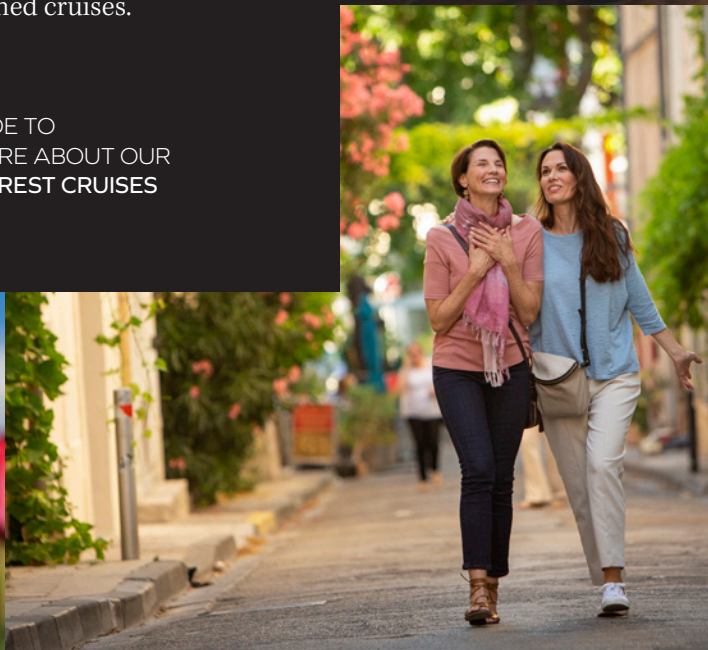



WE'VE GOT YOU COVERED.

NEARLY 100 YEARS OF EXPERIENCE BACKED
BY THE GLOBUS FAMILY OF BRANDS.

When you cruise with Avalon Waterways, the safety of our family — our travellers — is our top priority. Our entire team closely monitors situations at our destinations, and in the event of an incident, we implement ways to safely avoid trouble spots. As a global operator with over 50 offices worldwide, and the on-trip support of our expert Tour Directors, Cruise Directors and Local HostsSM, you can count on the Globus family of brands wherever you travel.

GLOBUS
family of brands





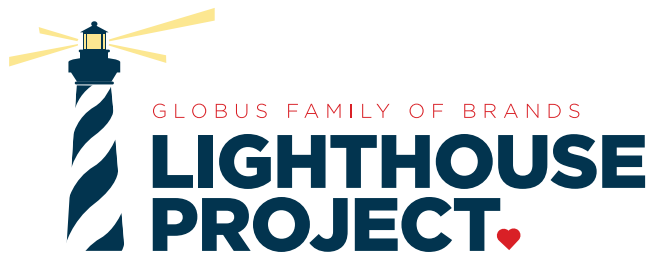

LIGHTING THE PATH TO A BETTER TOMORROW.

From our inception, Avalon Waterways® has cast a light on the world's most fascinating places and people – inviting wayfarers and wanderers like you to bask in their glory, intrigue, and wonder. Along the way, we've helped travellers uncover ancient traditions while meeting the locals dedicated to preserving them; to meander historic hallways while giving back to the societies that safeguard them; and to put down the guidebooks and pick up a greater understanding of the world and its people.

Immersed in enlightening experiences, we naturally gain a deeper appreciation – one that leads to greater compassion, consideration, and curiosity as we ask ourselves, what more can we do to protect our planet, preserve our sacred places, and help our friends around the globe.

GLOBUS FAMILY OF BRANDS LIGHTHOUSE PROJECT♥

Avalon, along with sister companies Globus and Cosmos, invite our travellers and partners to help us in supporting causes that provide for a more sustainable planet and a brighter tomorrow. The Avalon Waterways® Lighthouse Project shines brightly as an illuminating initiative where we can all come together to tread lightly and give generously for the globe's greater good.

A CLEANER PLANET IS THE BEST REWARD.

Avalon Waterways has been honoured by Europe's Green Award—recognised for our Suite ShipSM fleet's high safety and environmental standards. This prestigious award is given to river cruise ships based on the environmental impact of engines, fuel consumption, waste and maintenance, pollution prevention, and more.







CRUISING ELEVATED



WELCOME ABOARD

CHARTERS – INCENTIVES – MEETINGS – EVENTS – SPECIAL INTEREST

Please contact us for more information

Within Australia email: mice@avalonwaterways.com.au

Within New Zealand email: mice@avalonwaterways.co.nz